

Interior Hardwood Grille Application Guide

for Andersen® A-Series, 400 and 200 Series Windows and Patio Doors



Thank you for choosing Andersen.

For questions call 1-888-888-7020 Monday - Friday, 7 a.m. to 7 p.m. and Saturday, 8 a.m. to 4 p.m. central time. For more information and/or guides visit andersenwindows.com.

Please leave this guide with building owner.

- ▶ **Read guide from beginning to end before starting installation. Read all warnings and cautions during unit installation.**
- ▶ **Check with your local building code official to identify and confirm compliance with local building code requirements.**

⚠ WARNING

Use caution when working at elevated heights and around unit openings. Follow manufacturers' instructions for ladders and/or scaffolding. Failure to do so may result in injury or death.

⚠ WARNING

Follow manufacturers' instructions for hand or power tools. Always wear safety glasses. Failure to do so may result in injury and/or product damage.

⚠ WARNING

Windows and doors can be heavy. Use safe lifting techniques and a reasonable number of people with enough strength to lift, carry and install window and door products to avoid injury and/or product damage.

Parts Included

- Installation Guide
- Interior Hardwood Grille
- Fastener Installation Tool
- Barbed Fasteners

OR

- Flat Fasteners
- AND/OR**
- OSF Fastener/
Barbed OSF Fastener

Tools and Supplies

- Safety Glasses
- Pencil

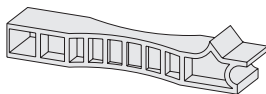

Fastener Installation Tool (Plastic)

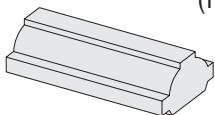

Fastener Installation Tool (Wood)

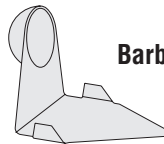

Barbed Fastener

Included In:

- Casement/Awning Picture Window
- Gliding Window
- Elliptical Window
- Flexiframe® Window
- Arch Window
- Springline™ Window
- Specialty Windows
- Frenchwood® Patio Doors
- Custom Pattern Grilles for:
Double-Hung Picture, Flexiframe®
and Specialty Windows



Barbed OSF Fastener

Included In:

- Woodwright® Double-Hung and Picture Windows
- A-Series Double-Hung, Casement, Awning, Venting Transom, Fixed Transom and Picture Windows.

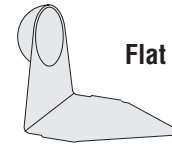

Flat Fastener

Included In:

- Casement/Awning Stationary Window
- Narrowline® Picture Window
- Perma-Shield® Gliding Patio Doors
- Custom Pattern Grilles for:
Narrowline® Picture, Casement/Awning,
and Casement/Awning Picture Windows

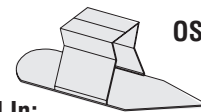

OSF Fastener

Included In:

- 200 Series Half Circle Windows
- 200 Series Inswing Patio Doors
- A-Series Hinged and Gliding Patio Doors
- Custom Pattern Grilles for:
400 Series Tilt-Wash, and Transom, and
Narrowline® Transom Windows

1. Locate and Prepare Notches (If Present)

- Locate notches around perimeter of glass for *Fastener* locations.
- Clip an *OSF Fastener* (provided) into end of plastic *Fastener Installation Tool*. Use fastener to clean out glazing material or widen notches if needed.

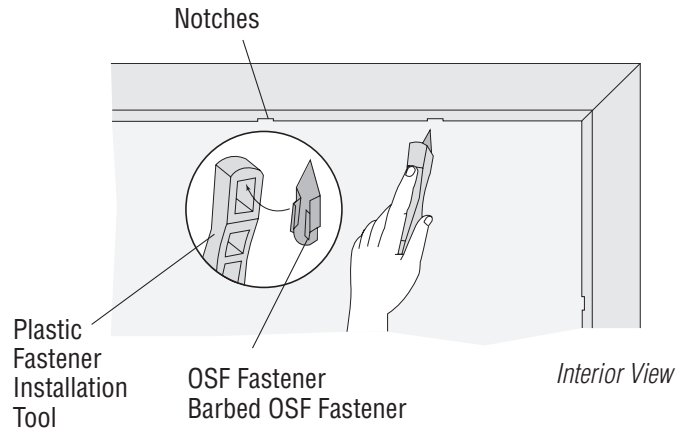

2. Mark Fastener Position (If Notches are Not Present)

CAUTION

Arch Windows

Grille Spokes on larger Interior Hardwood Grilles for Arch Windows are over formed for a quality fit. Carefully pull Grille Spokes down into position and place a light pencil mark where the center of each spoke meets Inside Glass Stop. Failure to do so may result in product damage.

- Position *Interior Hardwood Grille* in glass opening.
- Place a light pencil mark where center of each *Grille End* or *Grille Spoke* meets *Interior Wood Trim* or *Inside Glass Stop*. For Arch Window grilles that have a *Hub*, also place a light pencil mark opposite center of *Hub*.

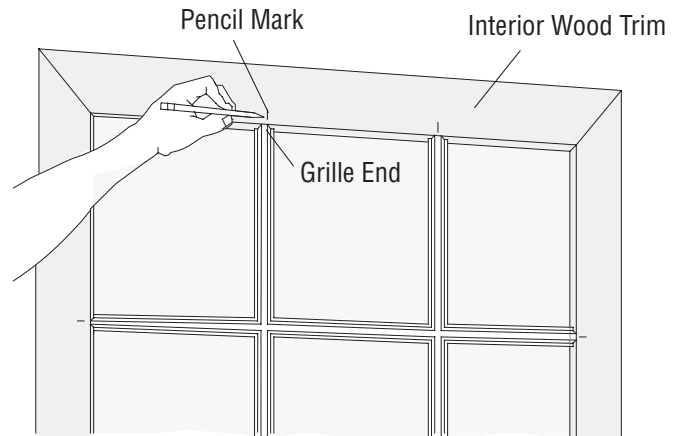

Picture Window Interior View

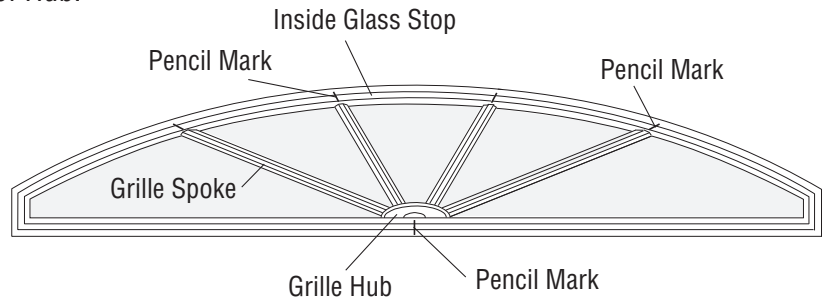

Arch Window Interior View

3. Position Fasteners

- Position *Fasteners* between glass surface and *Interior Wood Trim* or *Inside Glass Stop* at all pencil marks or notches, inserting only far enough to maintain position.
- Place *Fastener Installation Tool* against glass and carefully push *Fasteners* tight against *Interior Wood Trim* or *Inside Glass Stop*, keeping flat side against glass at all times.

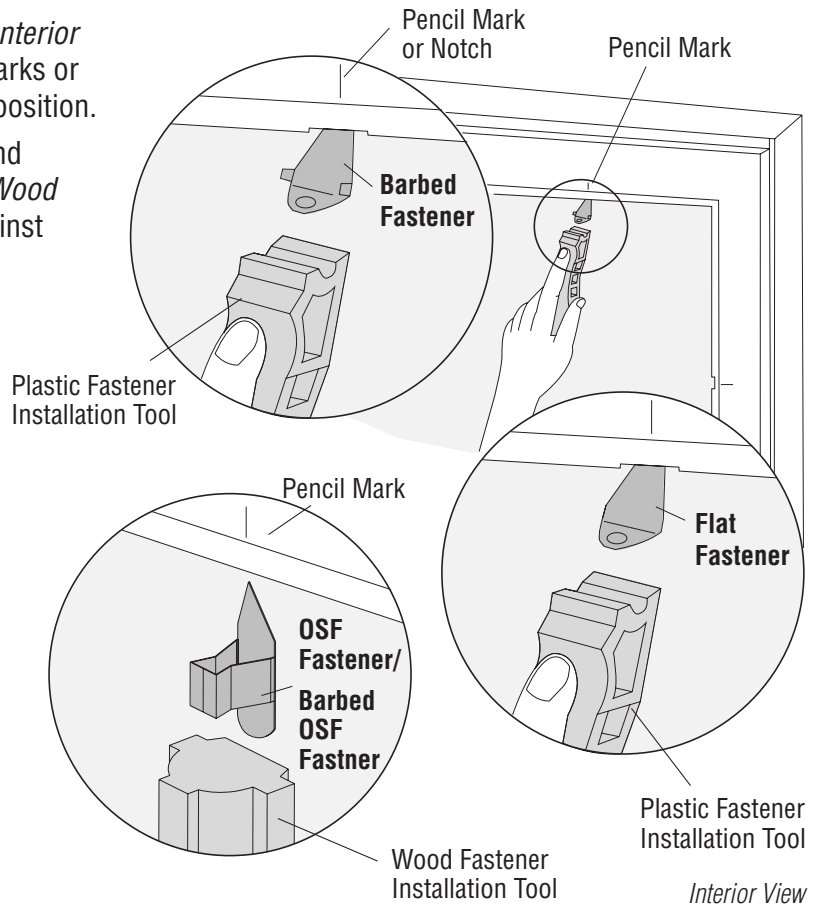

4. Install Interior Hardwood Grille

NOTICE

Double-Hung Venting Windows

7/8" and 1-1/8" Interior Hardwood Grilles, for Upper Sash of Tilt-Wash and Narroline® Double-Hung Windows, are notched to allow for free movement of the lock and keeper. Position notch to lower rail of Upper Sash.

Arch Windows

For Interior Hardwood Grilles with Hubs, insert Hub on bottom Fastener before proceeding to Grille Spokes.

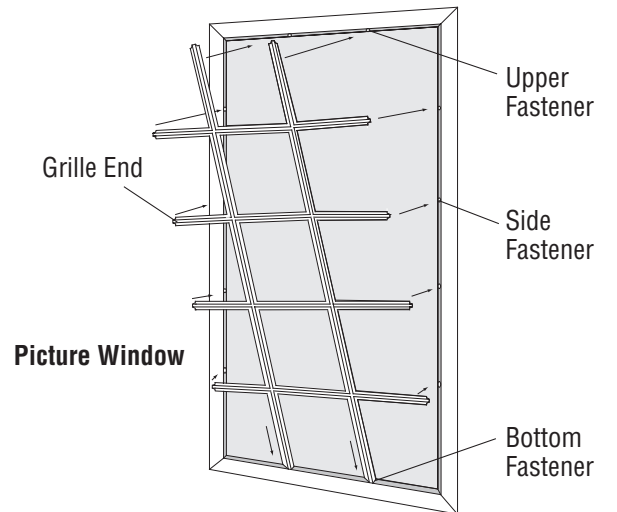

Interior Views

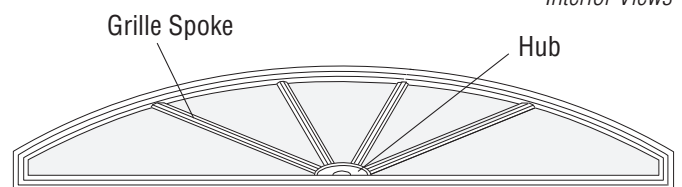

Arch Window

- Position *Interior Hardwood Grille* in opening.
- Insert *Grille Ends* onto bottom *Fasteners*. Lightly push downward on grille and snap *Grille Ends* onto upper *Fasteners*; then onto all side *Fasteners*.
- **To remove grille**, reverse this step.

4. Fastener Adjustments

- If *Interior Hardwood Grille* appears loose, remove grille and increase tension by gently bending *Fasteners* slightly toward grille.
- If *Interior Hardwood Grille* appears tight, remove grille and release tension by gently bending *Fasteners* slightly toward sash frame.

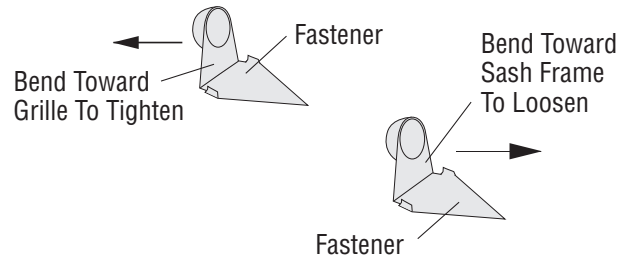

Finishing, Cleaning, and Maintenance Instructions

CAUTION

- **DO NOT** expose or store grilles in high moisture conditions, excessive heat, or humidity. Finish interior wood surfaces immediately after installation. Unfinished wood surfaces will discolor, deteriorate and/or may bow and split.
- **DO NOT** stain or paint weatherstrip, silicone beads, vinyl, glass or hardware.

INTERIOR FINISHING

Remove Interior Hardwood Grilles from unit. Read and follow finishing manufacturer's instructions and warnings on each container of finish material for priming, painting, staining and varnishing.

MAINTENANCE

Immediately sand and refinish any interior wood that becomes stained or mildewed to prevent further discoloration and/or damage. For further information, contact your local Andersen dealer. Dealers can be found in the Yellow Pages under Windows.