



**What's in This Section**

<b>Clad French Casement Windows</b>	<b>Page 3</b>
<b>Part Illustrations</b>	<b>3</b>
Parts Illustration - Operating Windows	3
Parts Illustration - Fixed Windows	5
<b>Unit Sizes</b>	<b>7</b>
Product Labels	7
Unit Sizes	7
<b>Sash</b>	<b>9</b>
Sash Illustration - Operating Windows	9
Sash Illustration - Fixed Windows	10
Replacement Sash	11
Reglazing Kits	11
Interior Glazing Stops	12
Sash Parts	13
<b>Insect Screens</b>	<b>14</b>
Insect Screens Illustration	14
Insect Screen Parts	15
<b>Grilles</b>	<b>16</b>
Interior and Exterior Grilles	16
Grille Profiles - Wood	17
Grille Profiles - Aluminum	18
Grille Profiles - Fibrex™	18
Standard Grille Patterns	19
Grille Parts	20
<b>Hardware</b>	<b>21</b>
Straight Arm Operators	21
Hinges - Butt	23
Multi Point Lock - Configurations	24
Multi Point Lock Parts	30
Frame Assembly - Operating Windows	31

Frame Assembly - Fixed Windows .....	33
Sash Stops .....	34
Extension Jambs .....	36
Frame Parts .....	37
<b>Joining Components .....</b>	<b>38</b>
Mullion Covers - Interior .....	38
Mullion Covers - Exterior .....	39
<b>Interior Casing .....</b>	<b>40</b>
Casing Profiles .....	40
Casing Parts .....	42
<b>Installation Components .....</b>	<b>44</b>
Installation Parts .....	44

# Andersen® Complementary Clad French Casement Windows (2005 to Present)

Operating and Fixed Windows

## Parts Illustration

### Parts Illustration - Operating Windows

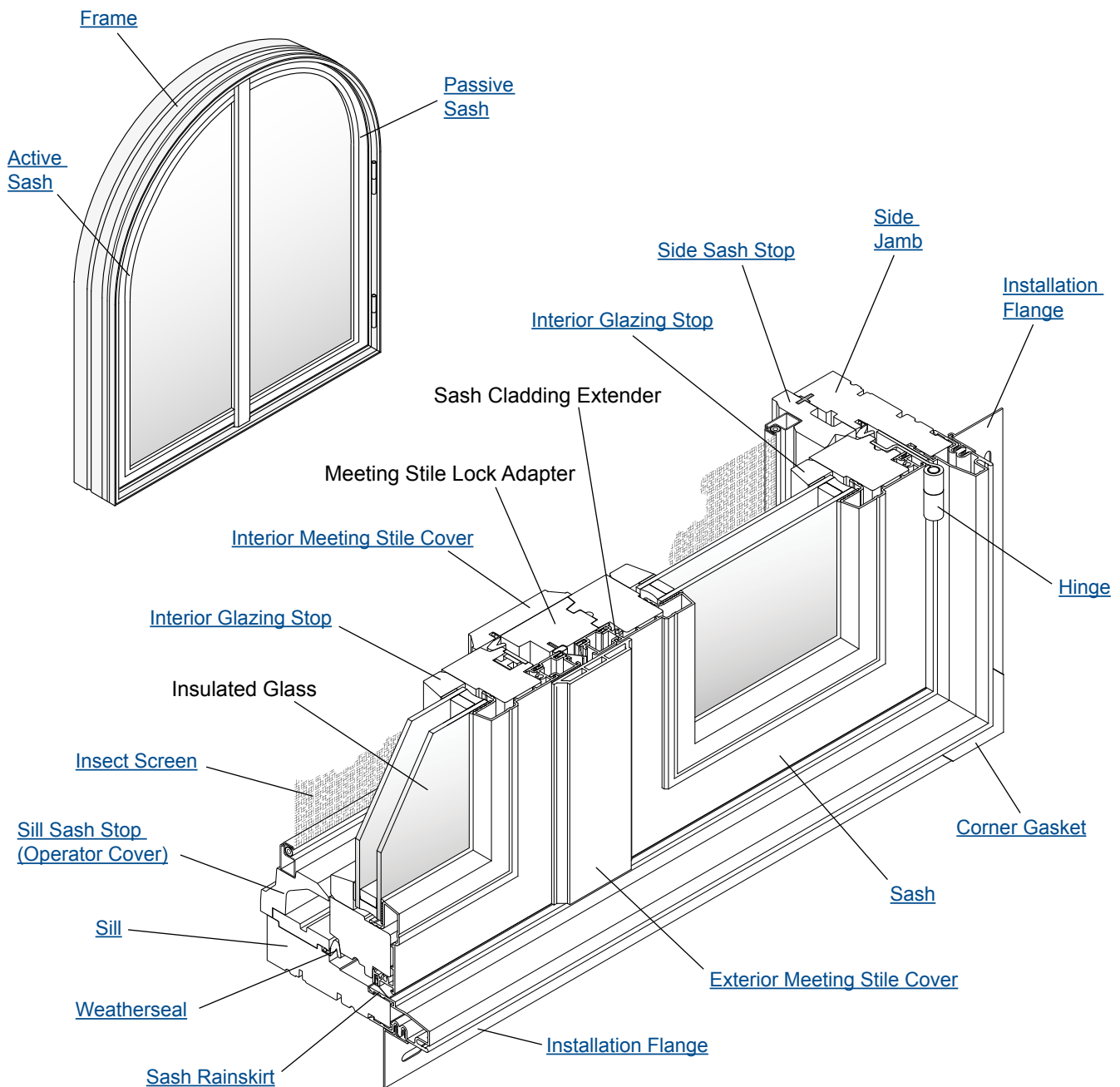

**Complementary Clad French Casement Window Unit Parts - Operating Window**

*Unit viewed from exterior*

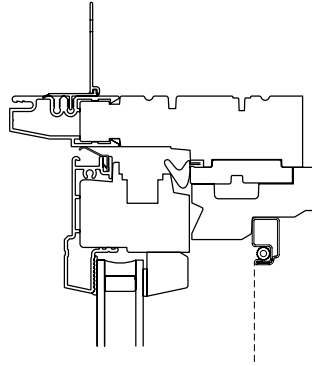
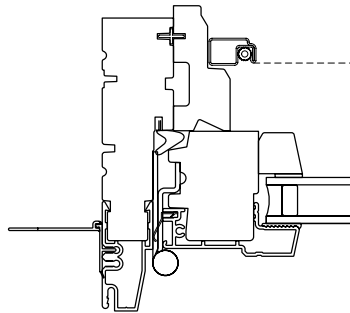
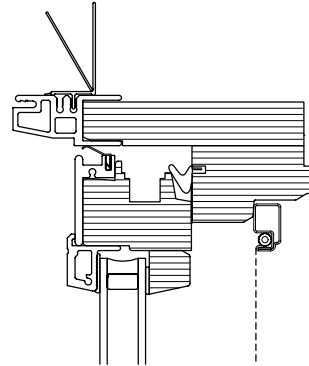
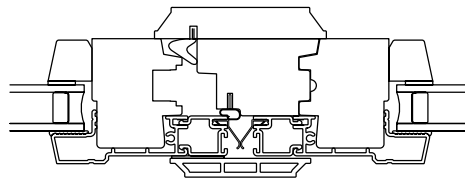
**Parts Illustration****Operating Windows**Lineal Head  
Cross SectionCurved Head  
Cross SectionSide Jamb  
Cross Section

Meeting Stile Cross Section

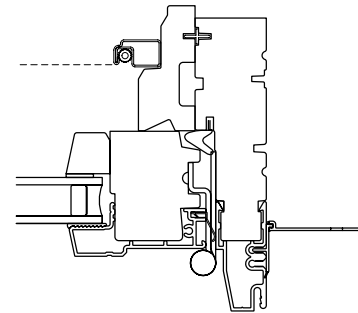
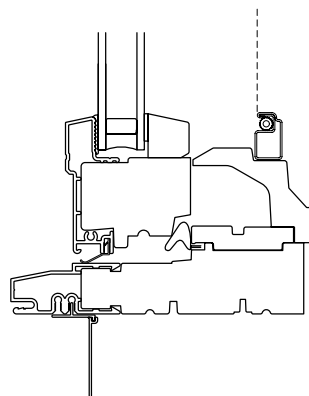
Side Jamb  
Cross SectionSill Cross  
Section**Complementary Clad French Casement Windows Unit Parts - Operating Windows**

Parts Illustration

Parts Illustration - Fixed Windows

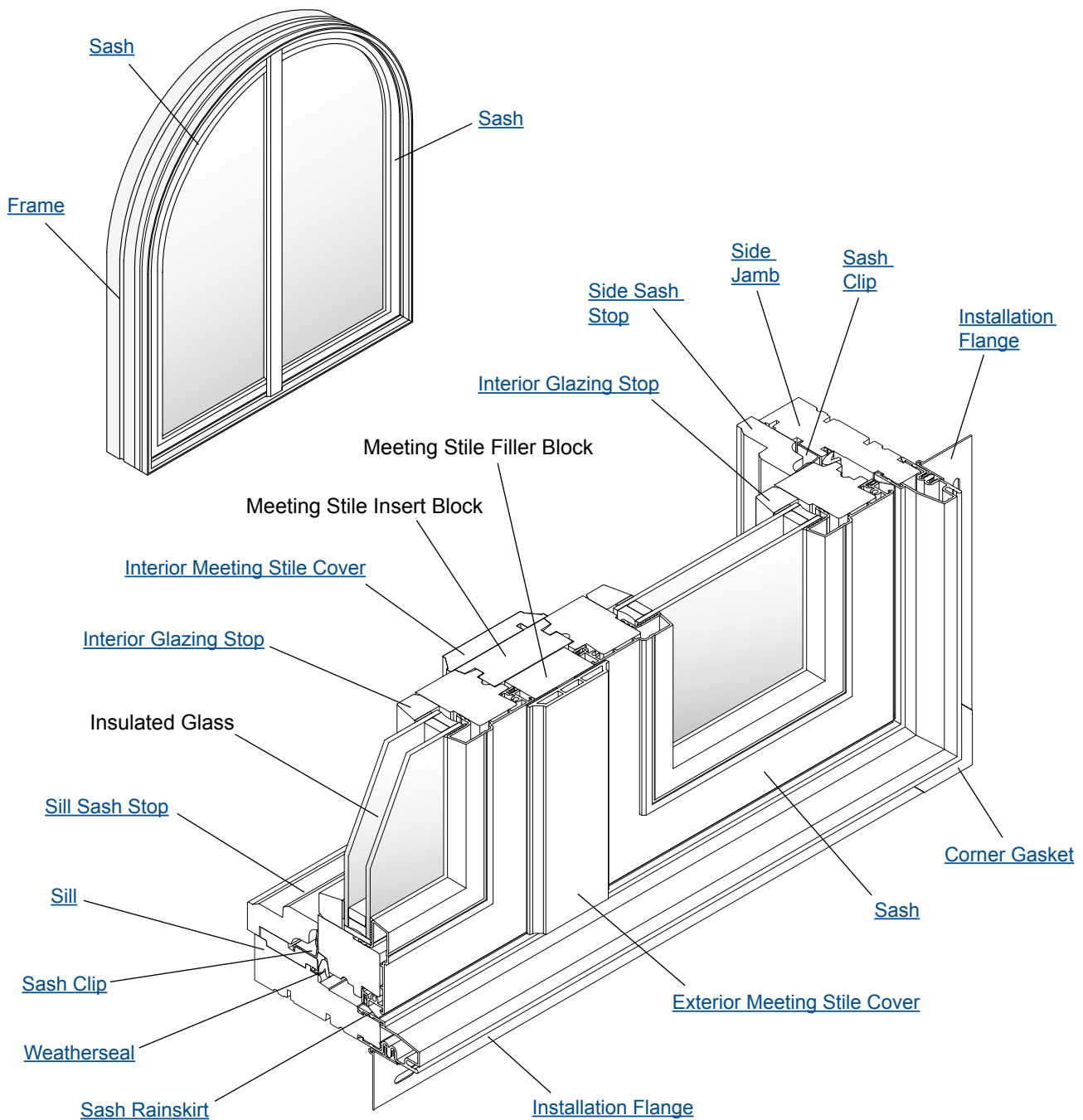

Complementary Clad French Casement Windows Unit Parts - Fixed Windows

Unit viewed from exterior

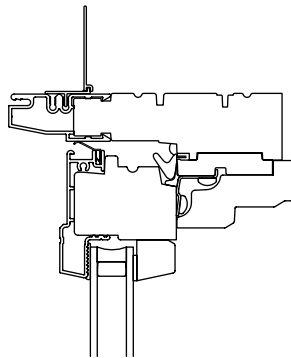
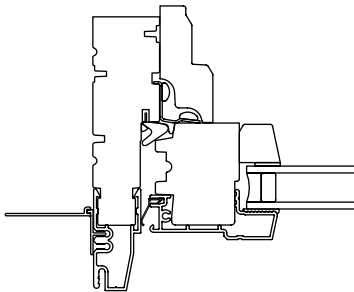
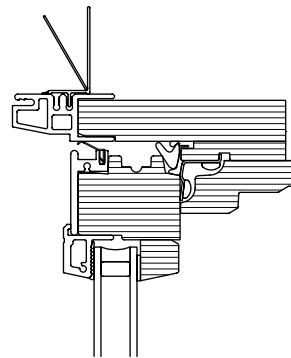
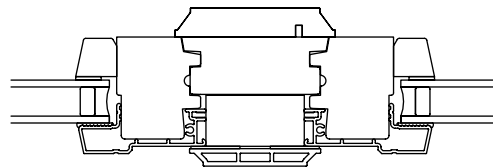
**Parts Illustration****Fixed Windows**Lineal Head  
Cross SectionCurved Head  
Cross SectionSide Jamb  
Cross Section

Meeting Stile Cross Section

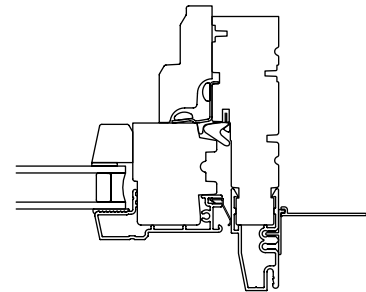
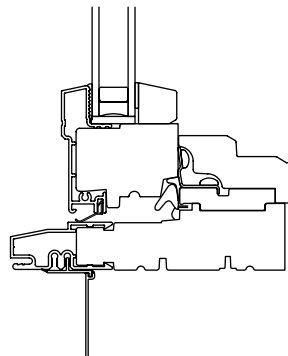
Side Jamb  
Cross SectionSill Cross  
Section**Complementary Clad French Casement Windows Unit Parts - Fixed Windows**

## Unit Sizes

### Product Labels

Clad french casement windows have an identification logo etched on the bottom right corner of the glass of each sash as viewed from the interior.

This identification logo contains a "P Number". The "P Number" is located directly below the Andersen® or KML by Andersen™ logo. "P Numbers" include both the Production Number and Line Item Number separated by an exclamation mark.

When ordering replacement parts, please provide the "P Number" and a brief description of the product and part required to ensure the replacement part(s) match the specifications of the original product. If unable to locate the "P Number" contact the appropriate Andersen® distributor.

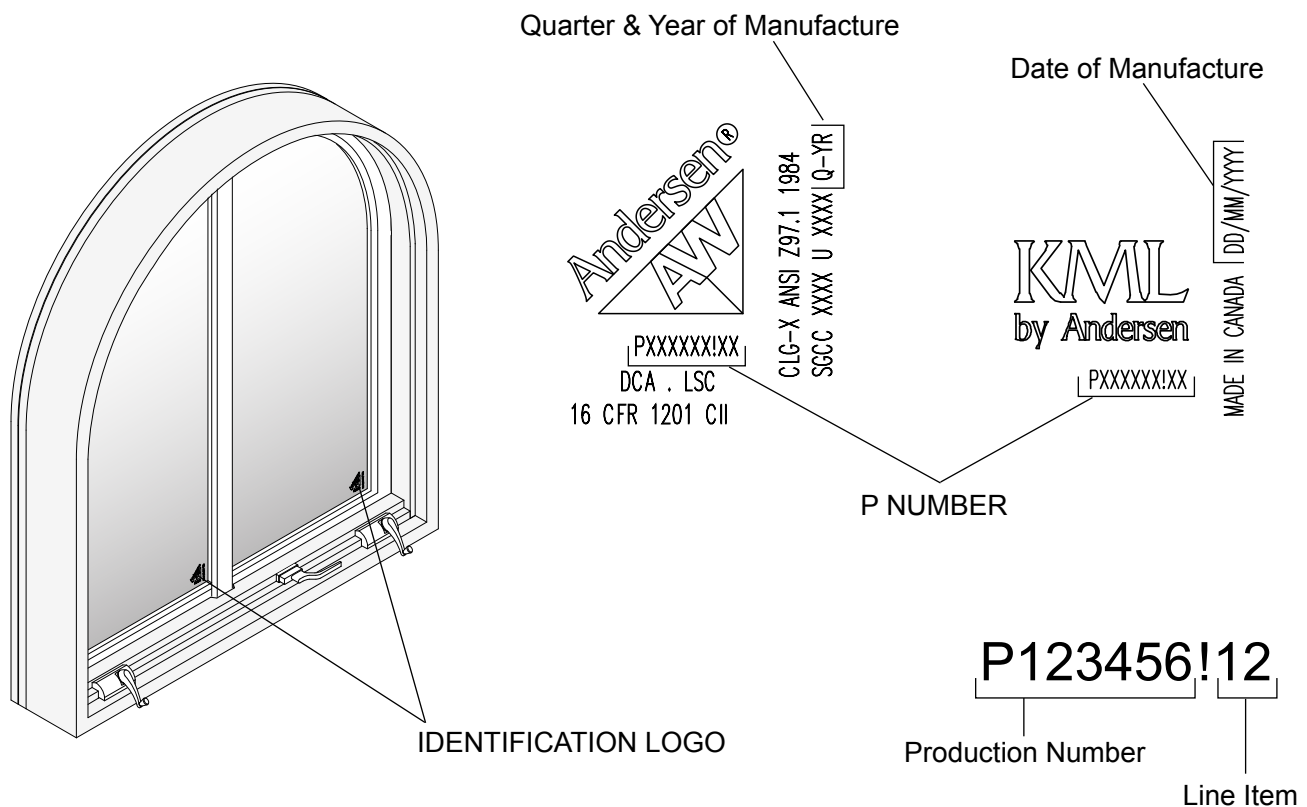

### Unit Sizes

#### Standard Sizes

Standard sizes are available to complement Andersen® 400 Series and 200 Series products.

#### Custom Sizes

Custom sizes are available. Sizes must fall within size ranges shown on next page. Not all sizes within size range can be operating.

## Unit Sizes

### Unit Sizes

Rectangle French  
Casement Window  
Sizes

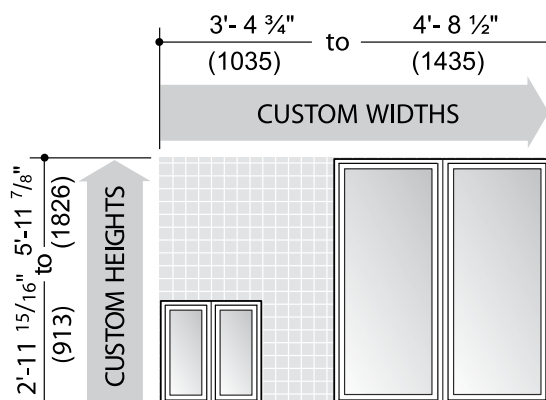

Archtop French  
Casement Window  
Sizes

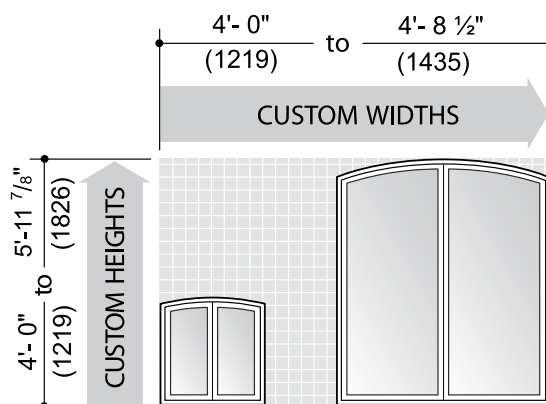

Springline™ French  
Casement Window  
Sizes

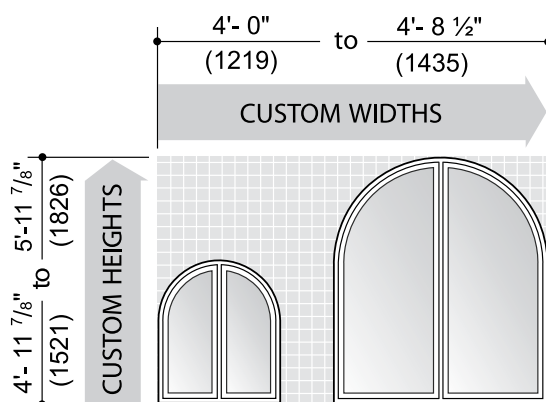



## Sash

### Sash Illustration - Operating Windows

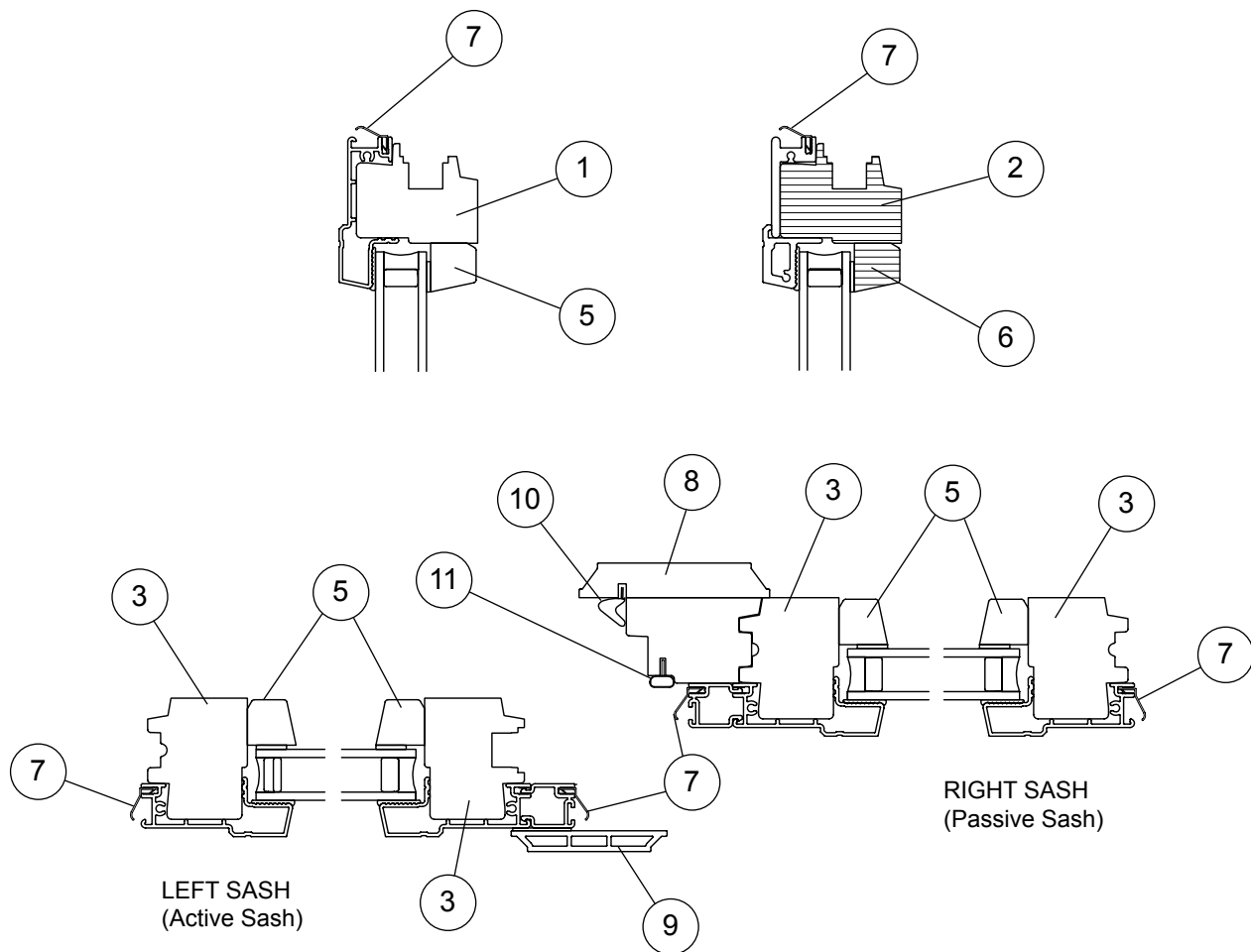

1. Head Rail
2. Curved Head Rail
3. Side Stile
4. Bottom Rail
5. [Interior Glazing Stop](#)
6. [Curved Glazing Stop](#)
7. [Sash Rainskirt](#)
8. [Interior Meeting Stile Cover](#)
9. [Exterior Meeting Stile Cover](#)
10. [Foam Weatherseal](#)
11. [Bulb Weatherseal](#)

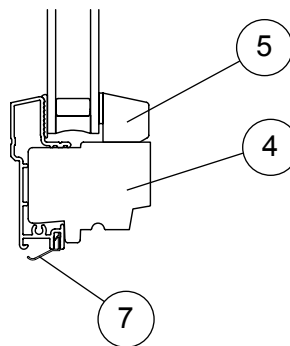

### Complementary Clad French Casement Windows - Operating Sash

## Sash

### Sash Illustration - Fixed Windows

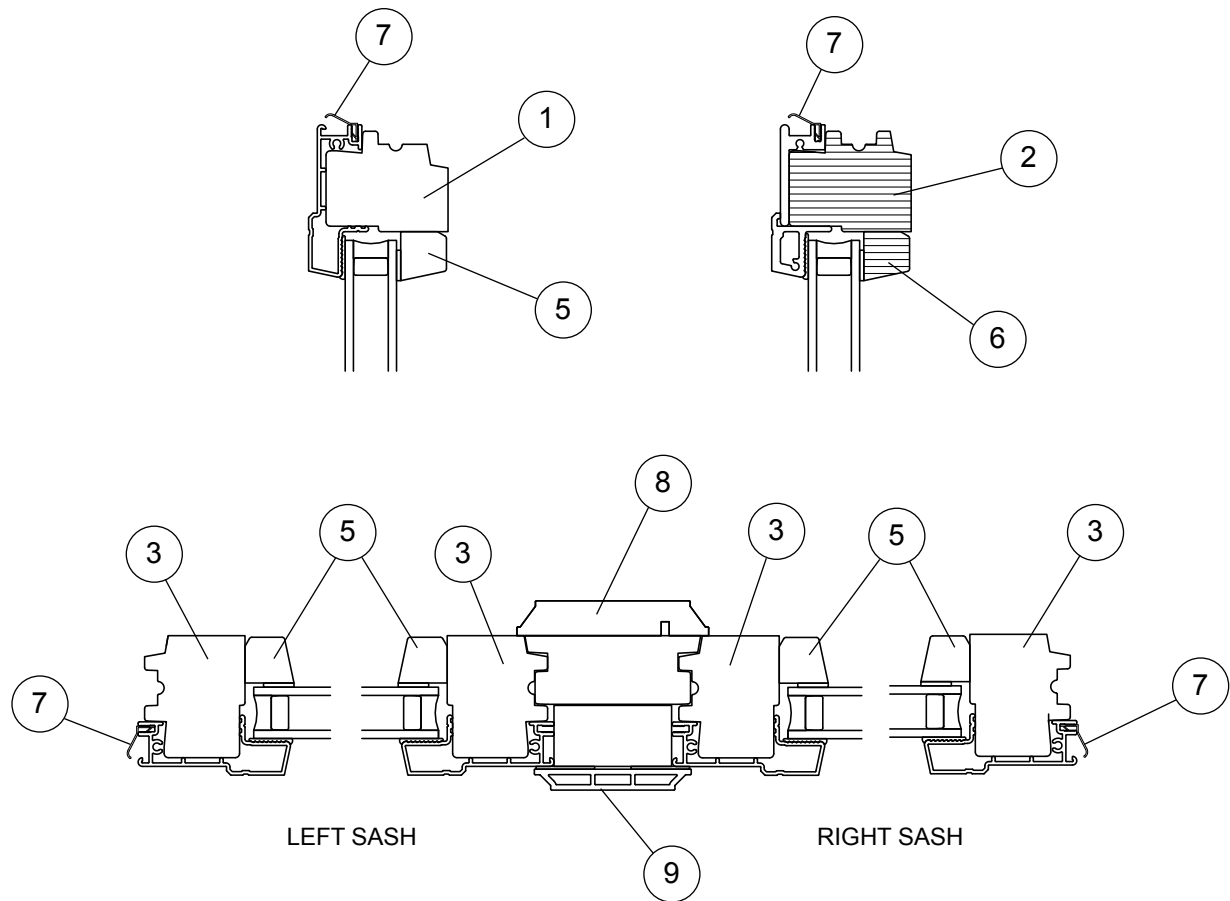

- 1. Head Rail
- 2. Curved Head Rail
- 3. Side Stile
- 4. Bottom Rail
- [5. Interior Glazing Stop](#)
- [6. Curved Glazing Stop](#)
- [7. Sash Sill Rainskirt](#)
- [8. Interior Meeting Stile Cover](#)
- [9. Exterior Meeting Stile Cover](#)

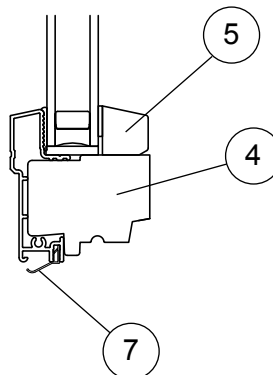

### Complementary Clad French Casement Windows - Fixed Sash

## Sash

### Replacement Sash

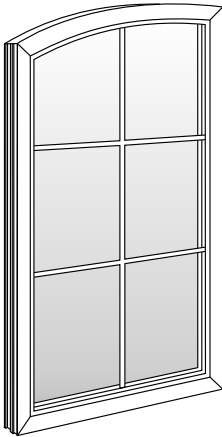

**Note:**

Replacement sash are made to order.

To order, state:

1. **Description of Part** (replacement sash)
2. **Quantity**
3. **Left or Right sash** (as view from exterior)
4. **P number** (from product label, see [page 7](#))

### Reglazing Kits

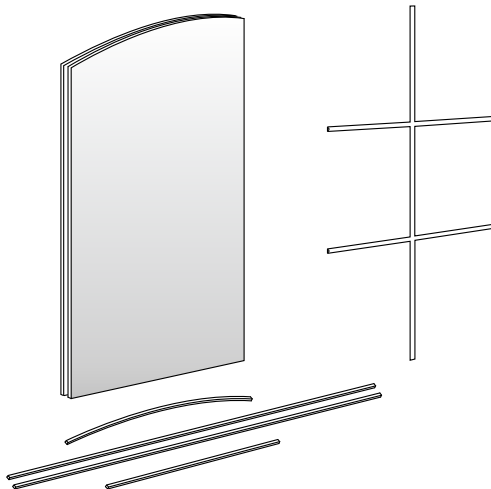

**Kit Includes:**

Glass unit.

Interior glazing stops and permanent grilles are optional and must be ordered separately.

Glazing stops and grilles have tape applied.

**Note:**

Reglazing kits are made to order.

To order, state:

1. **Description of Part** (reglazing kit)
2. **Quantity**
3. **Left or Right** (as view from exterior)
4. **P number** (from product label, see [page 7](#))

## Sash

### Interior Glazing Stops

**Note:**

Interior glazing stops available in pine, oak, mahogany, maple, cherry, Douglas fir, alder, and prefinished white.

#### Interior Glazing Stop - $\frac{1}{2}$ " / Lineal *Ref. No. 5 [page 9](#), & [10](#)*

	<b>Note:</b> Used on decorative insulating art glass.	ACP Order No.	AW Order No.
		PF1008	



#### Interior Glazing Stop - $\frac{1}{2}$ " / Curved *Ref. No. 6 [page 9](#), & [10](#)*

	<b>Note:</b> Used on decorative insulating art glass.	ACP Order No.	AW Order No.
		PF1016	



#### Interior Glazing Stop - $\frac{5}{8}$ " / Lineal & Curved *Ref. No. 5 & 6 [page 9](#), & [10](#)*

	<b>Note:</b> Used on dual pane units.	ACP Order No.	AW Order No.
		PF1755	



#### Interior Glazing Stop - $1 \frac{3}{16}$ " / Lineal & Curved *Ref. No. 5 & 6 [page 9](#), & [10](#)*

	<b>Note:</b> Used on single pane units.	ACP Order No.	AW Order No.
		PF1011	



## Sash

### Sash Parts

#### Rainskirt Ref. No. 7 [page 9](#), & [10](#)

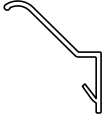
	<b>Note:</b> Available in lengths up to 94".	ACP Order No.	AW Order No.
		PF1026	

#### Weatherseal - Bulb / Operating Sash Ref. No. 11 [page 9](#)

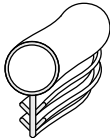
		ACP Order No.	AW Order No.
		442	

#### Meeting Stile Cover - Interior Ref. No. 8 [page 9](#), & [10](#)

	<b>Note:</b> Available in pine, oak, mahogany, maple, cherry, Douglas fir, alder, and prefinished white.	ACP Order No.	AW Order No.
		PF1884	

#### Meeting Stile Cover - Exterior / Aluminum Ref. No. 9 [page 9](#), & [10](#)

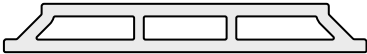
	<b>Note:</b> Available in 21 standard and any custom color.	ACP Order No.	AW Order No.
		PF1783	

## Insect Screens

### Insect Screens Illustration

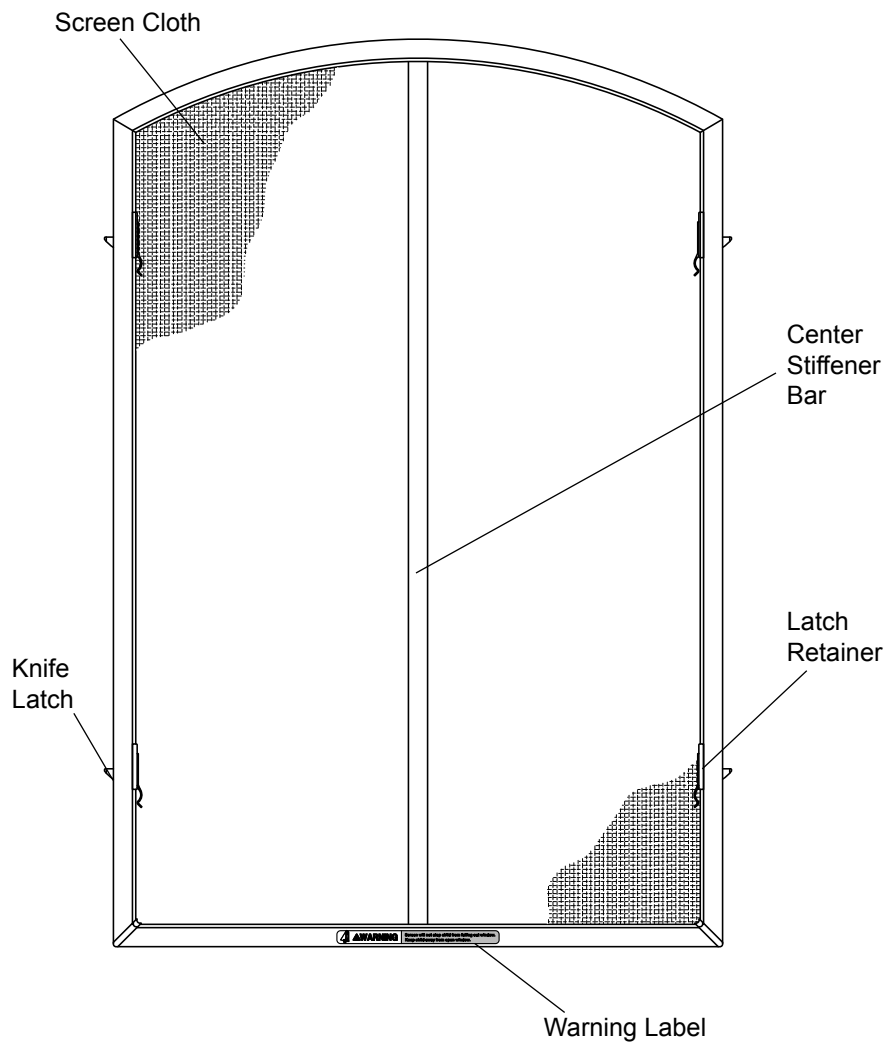
**Note:**

Replacement insect screens are made to order.

To order, state:

1. **Description of Part (insect screen)**
2. **Quantity**
3. **P number (from product label, see [page 7](#))**

### Complementary Clad French Casement Windows - Insect Screen

Insect Screens

**Insect Screen Parts**

**Warning Label - Insect Screen**

		ACP Order No.	AW Order No.
		105092	
<div><div></div><div><b>WARNING</b></div><div>Screen will not stop child from falling out window. Keep child away from open window.</div></div>			

**Knife Latch - Insect Screen**

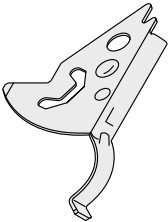
		Orientation	ACP Order No.	AW Order No.
		Left	104162	
		Right	104163	

**Latch Retainer - Insect Screen**

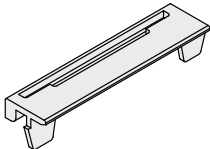
		Color	ACP Order No.	AW Order No.
		Stone	105094	
		White	104164	
		Terratone®	104165	
		Sandtone	104166	

**Strike - Insect Screen**

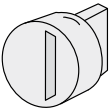
		Color	ACP Order No.	AW Order No.
		Natural	105091	
		White	105090	

## Grilles

### Interior and Exterior Grilles

#### Full Divided Light

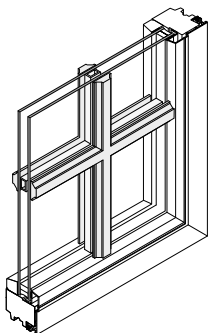

Permanent Exterior  
Permanent Interior  
With Spacer

#### Simulated Divided Light

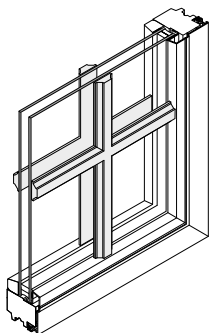

Permanent Exterior  
Permanent Interior

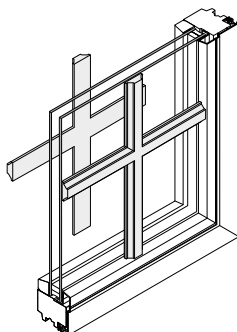

Permanent Exterior  
Removable Interior

#### Easy Clean Options

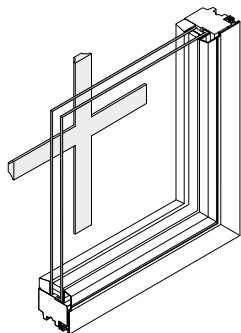

Removable Interior

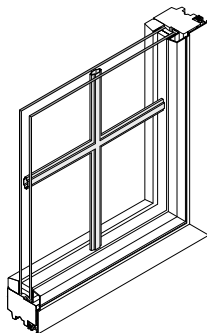

Finelight™ Between-the-Glass

#### Note:

Replacement interior and exterior grilles are made to order.

All grille configurations are available with interiors and exteriors to match interiors and exteriors of windows.

To order, state:

1. **Description of Part** (interior or exterior and type of grille)
2. **Quantity**
3. **P number** (from product label, see [page 7](#))



## Grilles

### Grille Profiles - Wood

**Note:**

Standard grille and divided light bars are for interior use only. Available in pine, oak, mahogany, maple, cherry, Douglas fir, alder, and prefinished white.

#### Standard Grille Bars

3/4"



PF1717

#### Roman Ogee Style



PF1828

7/8"



PF1718



PF1829



GBD178

1 1/8"



PF1719



PF1830

#### Divided Light Bars

#### Chamfer Style

#### Roman Ogee Style

3/4"



PF1720

7/8"



PF1721



PF1888

1 1/8"

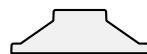

PF1722



PF1889

1 1/2"



PF2050



PF1954

2 1/4"

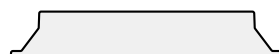

PF1723

### Complementary Clad Casement Windows - Wood Grille Profiles

## Grilles

### Grille Profiles - Aluminum

**Note:**

Aluminum divided light bars are for exterior use only. Available in 21 standard and any custom color.

**Divided Light Bars**
**Chamfer Style**
**Roman Ogee Style**
 $\frac{3}{4}"$ 

PF1780

 $\frac{7}{8}"$ 

PF1781



PF1861

 $1 \frac{1}{8}"$ 



PF1782



PF1862

 $1 \frac{1}{2}"$ 

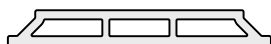
PF1953

 $2 \frac{1}{4}"$ 

PF1783

**Complementary Clad Casement Windows - Aluminum Grille Profiles**

### Grille Profiles - Fibrex™

**Note:**

Fibrex™ divided light bars are for interior and exterior use. Available in 21 standard and any custom color.

**Divided Light Bars**
**Chamfer Style**
 $\frac{3}{4}"$ 



PF1623

 $\frac{7}{8}"$ 

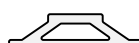
PF1624

 $1 \frac{1}{8}"$ 

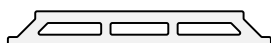
PF1625

 $2 \frac{1}{4}"$ 

PF1626

**Complementary Clad Casement Windows - Fibrex™ Grille Profiles**

Standard Grille Patterns

**Note:**  
Custom grille patterns are available.

**Colonial**

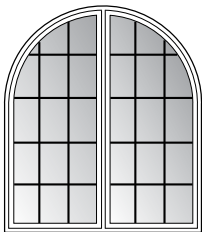
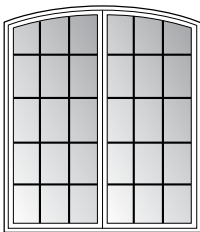
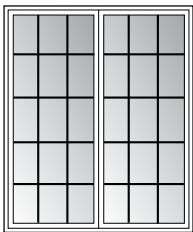

**Renaissance**

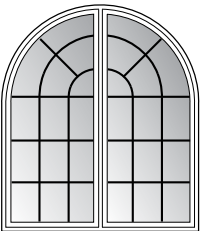
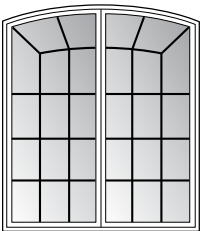

**Prairie**

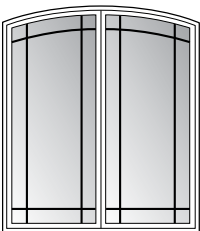
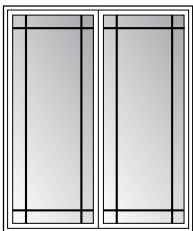

Complementary Clad French Casement Windows - Grille Patterns

## Grilles

### Grille Parts

**Note:**

All grille surrounds available in pine, oak, mahogany, maple, cherry, Douglas fir, alder, and prefinished white.

#### Grille Surround - 1/2" / Lineal & Curved

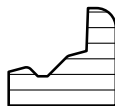
 	<b>Note:</b> Used with PF1008 & PF1016 glass stop.	ACP Order No.	AW Order No.
		PF1108	

#### Grille Surround - 5/8" / Lineal & Curved

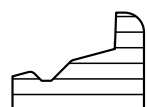
 	<b>Note:</b> Used with PF1755 glass stop.	ACP Order No.	AW Order No.
		PF1756	

#### Grille Surround - 1 3/16" / Lineal & Curved

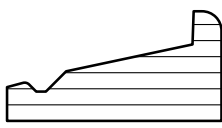
 	<b>Note:</b> Used with PF1011 glass stop.	ACP Order No.	AW Order No.
		PF1230	

#### Surround Clip

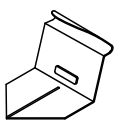
		ACP Order No.	AW Order No.
		1364	

#### End Clip - Grilles *(September 2007 to Present)*

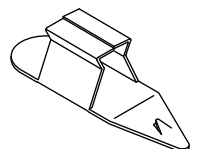
		Color	ACP Order No.	AW Order No.
		White	105444	
		Terratone™	105445	
		Sandtone	105446	
		Forest Green	105447	

## Straight Arm Operators

**Note:**

Operators are handed. Left hand operator shown.

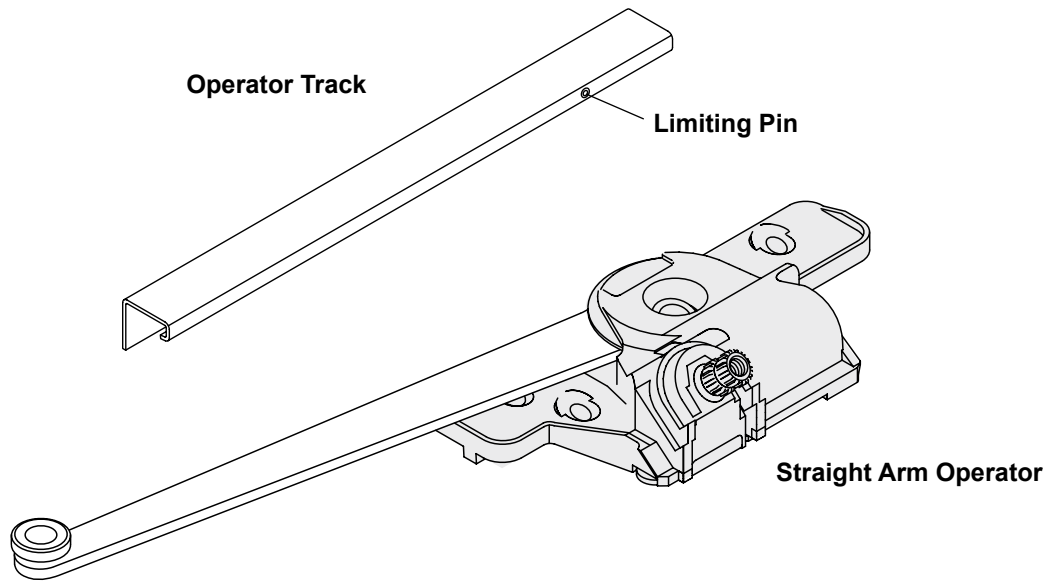

Complementary Clad French Casement Windows - Straight Arm Operator and Track

### Straight Arm Operator (May 2009 to Present)

	Unit Width	Orientation	ACP Order No.	AW Order No.
	40.750" - 47.999"	Left	112972	
		Right	112973	
	48.000" - 55.499"	Left	112974	
		Right	112975	
	55.500" - 56.500"	Left	112976	
		Right	112977	

### Track - Operator (May 2009 to Present)

**Note:**

Position of limiting pin along operator track is based on unit shape & size and orientation of sash.

ACP Order No.	AW Order No.
112979	

## Hardware

### **Straight Arm Operators** *(September 2007 to May 2009)*

**Note:**

Operators were available in 2 sizes and both left and right handed. Rod were available in 2 lengths.

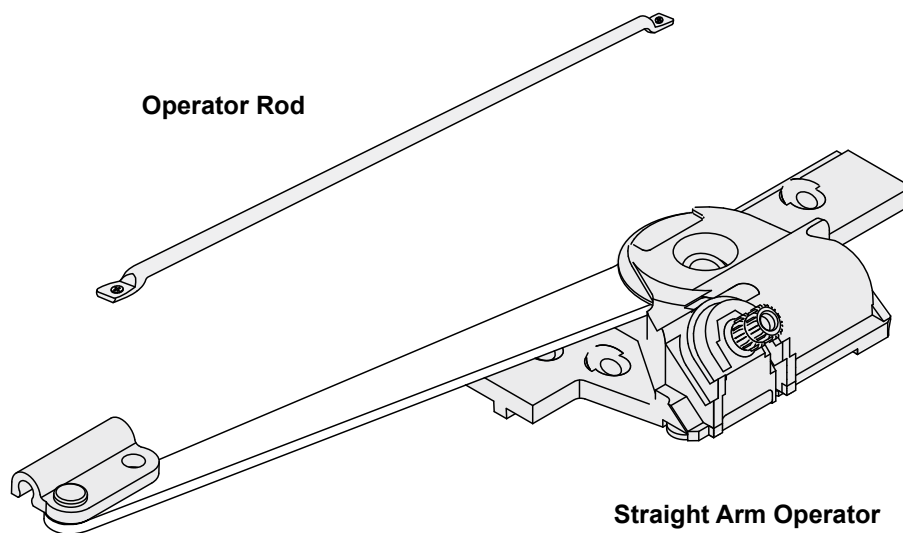

**Complementary Clad French Casement Windows - Straight Arm Operator and Rod**

**Note:**

This vintage of operator is no longer available. When ordering replacement operators for this vintage, please supply the original unit P#. An operator conversion kit will be supplied (includes 2 operators, 2 tracks, screws and wood sill sash stop (operator cover)).

Hardware

Hinges - Butt

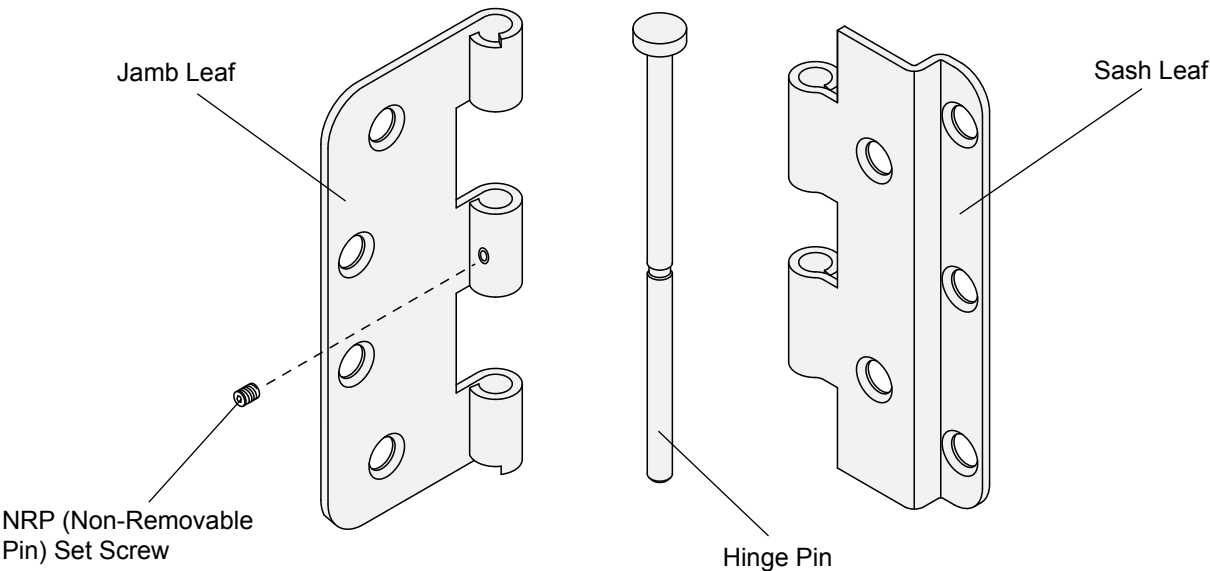

Complementary Clad French Casement Windows - Butt Hinges

Butt Hinge - Complete Assembly / Stainless Steel			
	<b>Note:</b> Hinges can be assembled in left or right hand configuration.	<b>ACP Order No.</b>	<b>AW Order No.</b>
		106257	
Set Screw - NRP / Butt Hinge			
	<b>Note:</b> #6-32 Hex Set Screw.	<b>ACP Order No.</b>	<b>AW Order No.</b>
		106994	

## Hardware

### Multi Point Lock - Configurations

**Note:**

Multi Point lock is always located in the left sash (active sash) as viewed from exterior.

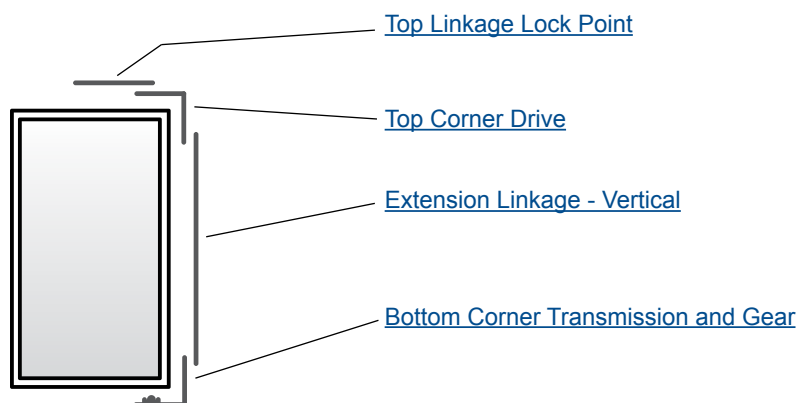
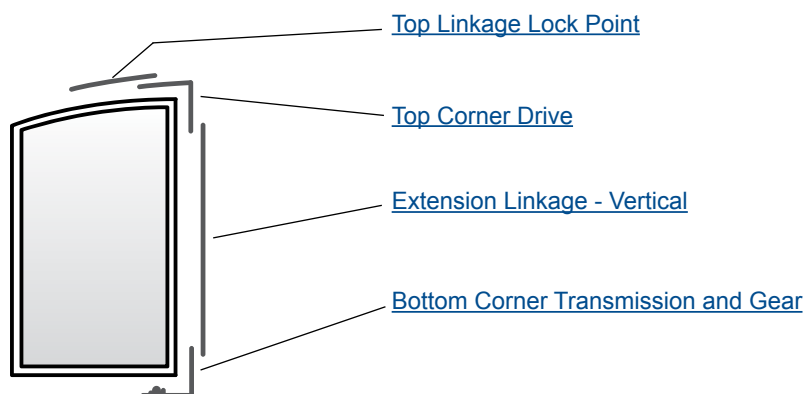
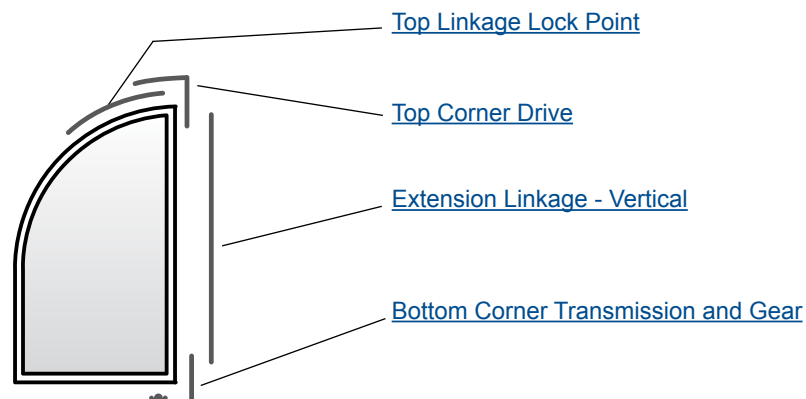
**Rectangular  
Active Sash**

**Arch Top  
Active Sash**

**Springline™  
Active Sash**

### Complementary Clad French Casement Window Hardware - Multi Point Configurations

*Viewed from exterior*



# Andersen® Complementary Clad French Casement Windows (2005 to Present)

Operating And Fixed Windows

## Hardware

### Note:

Lock system changed in April 2017. Replacement lock components for vintages prior to this will require the complete locking system to be replaced as well as the keeper location jig (part # 115955) to be ordered. Please supply the original P# when ordering the lock parts to ensure that the correct parts are supplied.

### Bottom Corner

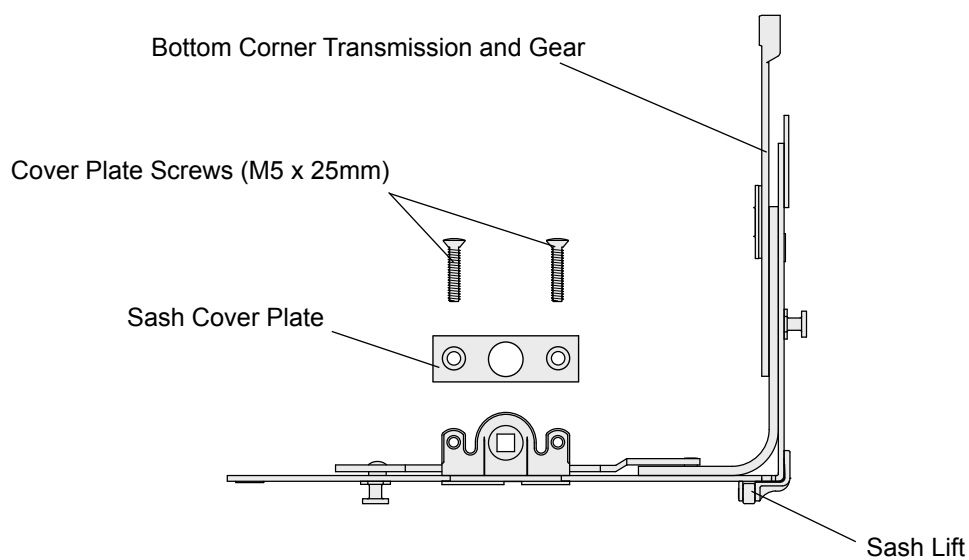

### Bottom Corner Transmission and Gear

		ACP Order No.	AW Order No.
		115914	

### Sash Cover Plate

		ACP Order No.	AW Order No.
		106082	

### Cover Plate Screw

		ACP Order No.	AW Order No.
	<b>Note:</b> M5 x 25mm	102920	

## Hardware

### Extension Linkage - Vertical

**Note:**

Extension linkage connects to bottom corner transmission and gear along side of sash.

Length of extension linkage is adjusted to suit unit frame height.

To order, state:

1. **Description of Part (Extension Linkage)**
2. **Quantity**
3. **EFS of unit or length of old extension linkage**
4. **P number (from product label, see [page 7](#))**

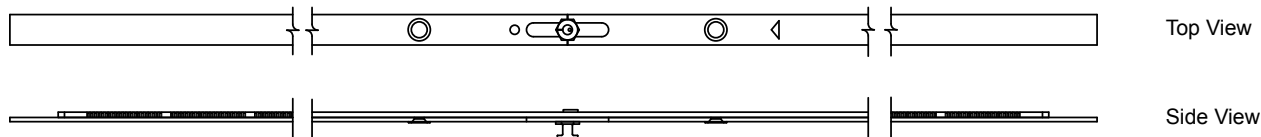

### Extension Linkage - 26 <sup>9</sup>/<sub>16</sub>"

**Note:**

Used on rectangular and arch top units from 21" to 26 <sup>3</sup>/<sub>16</sub>" tall or Springline™ units from 24 <sup>5</sup>/<sub>8</sub>" to 29 <sup>13</sup>/<sub>16</sub>" tall.

**ACP Order No.**

115911

**AW Order No.**

### Extension Linkage - 32 <sup>5</sup>/<sub>16</sub>"

**Note:**

Used on rectangular and arch top units from 26 <sup>7</sup>/<sub>32</sub>" to 45 <sup>13</sup>/<sub>16</sub>" tall or Springline™ units from 29 <sup>27</sup>/<sub>32</sub>" to 49 <sup>7</sup>/<sub>16</sub>" tall.

**ACP Order No.**

115910

**AW Order No.**

### Extension Linkage - 46 <sup>7</sup>/<sub>16</sub>"

**Note:**

Used on rectangular and arch top units from 45 <sup>27</sup>/<sub>32</sub>" to 59 <sup>29</sup>/<sub>32</sub>" tall or Springline™ units from 49 <sup>15</sup>/<sub>32</sub>" to 63 <sup>9</sup>/<sub>16</sub>" tall.

**ACP Order No.**

115909

**AW Order No.**

### Extension Linkage - 64 <sup>1</sup>/<sub>2</sub>"

**Note:**

Used on rectangular and arch top units from 59 <sup>15</sup>/<sub>16</sub>" to 78" tall or Springline™ units from 63 <sup>19</sup>/<sub>32</sub>" to 81 <sup>1</sup>/<sub>2</sub>" tall.

**ACP Order No.**

115908

**AW Order No.**

Hardware

Top Corner Drive - Rectangular & Arch Top Units

**Note:**  
Top corner drive connects to extension linkage.

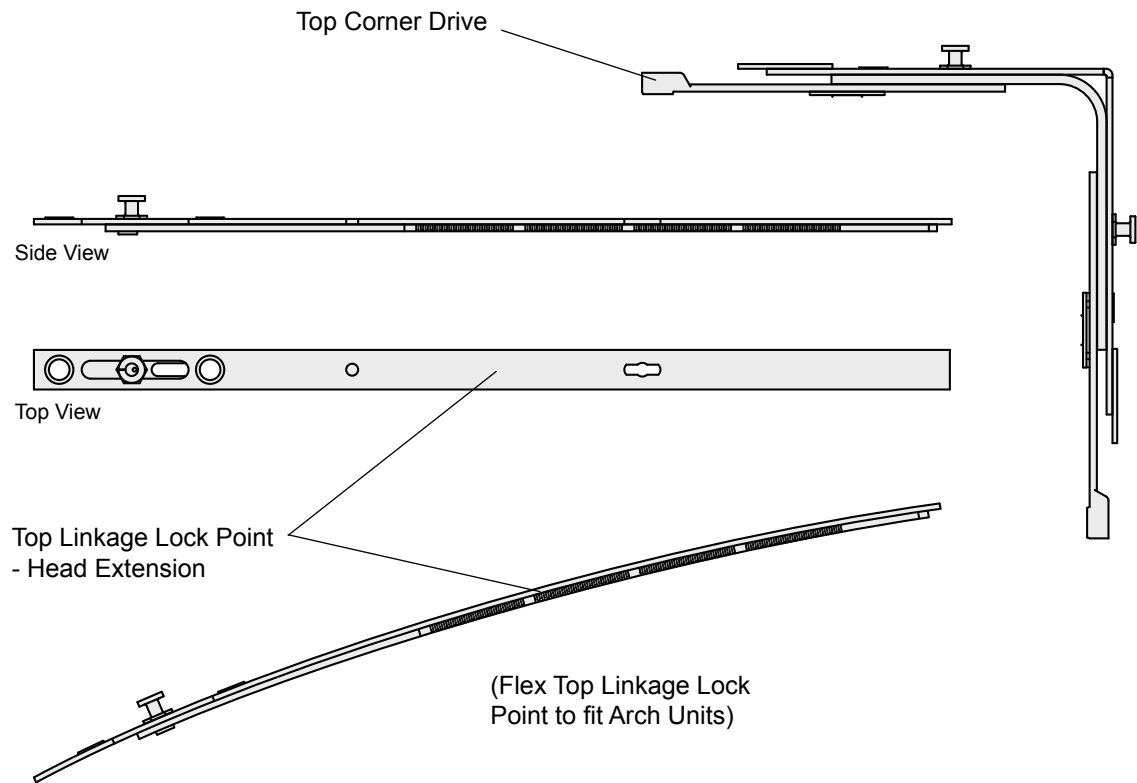

Top Corner Drive

ACP Order No.	AW Order No.
115913	

Top Linkage Lock Point - Head Extension

ACP Order No.	AW Order No.
115912	

Hardware

Top Corner Drive - Springline™

**Note:**  
Locking bolt connects to extension linkage. Top corner drive connects to locking bolt.

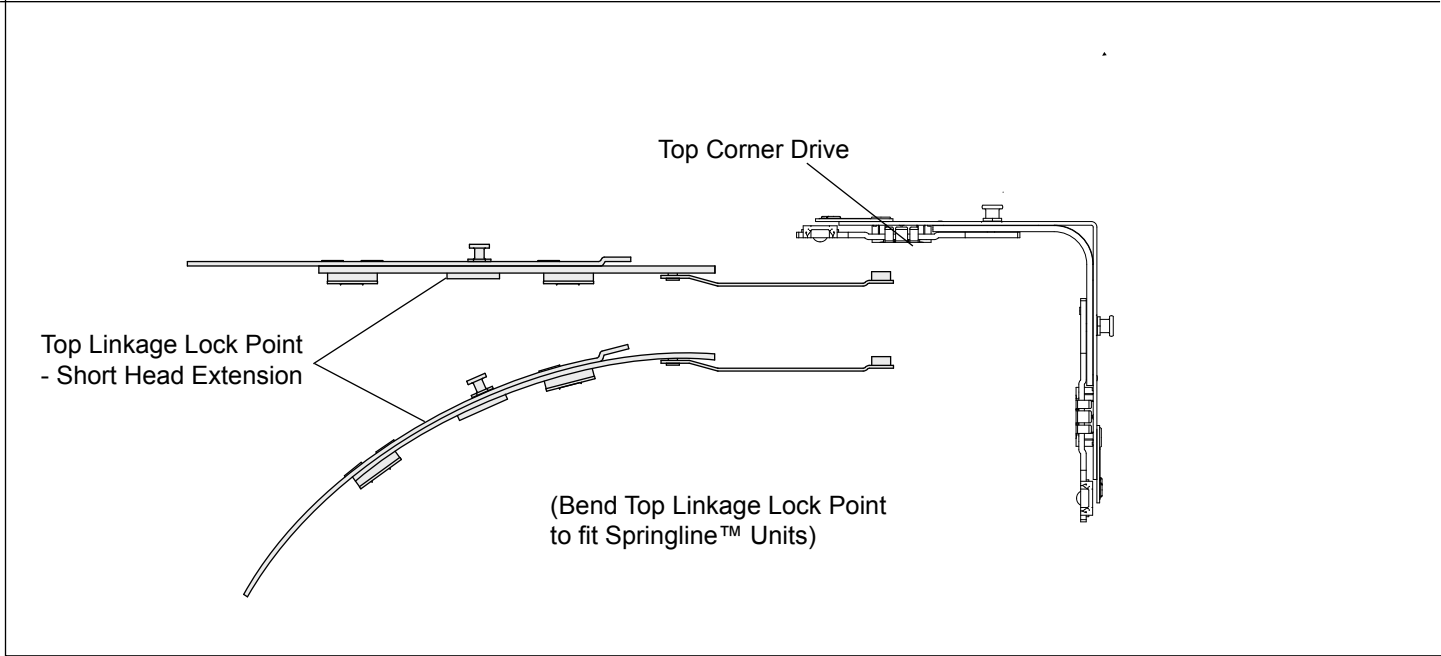

Top Corner Drive		
	ACP Order No.	AW Order No.
	115913	

Top Linkage Lock Point - Short Head Extension		
	ACP Order No.	AW Order No.
	115935	

## Hardware

### Lock Handle

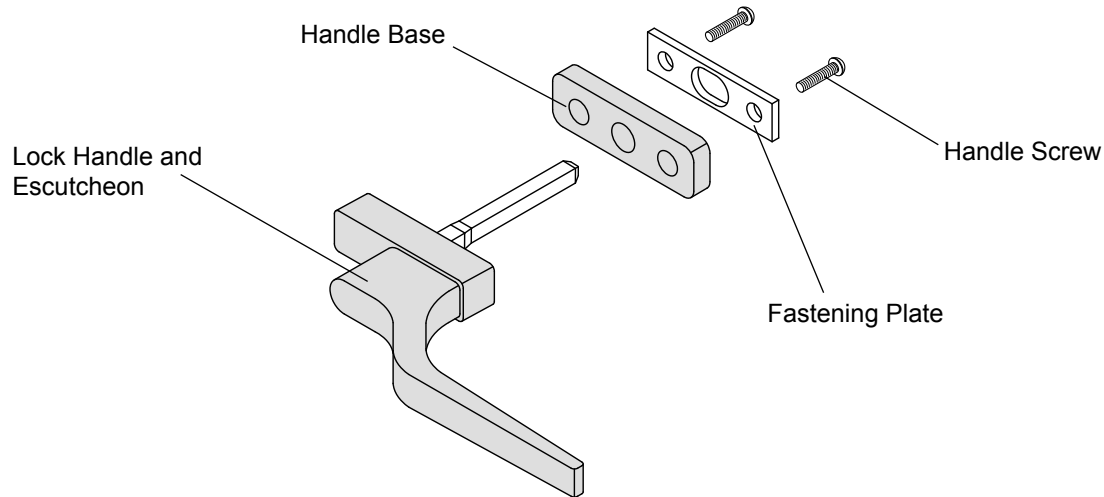

### Lock Handle and Escutcheon

**Note:**

Fastening plate supplied with lock handle.

Finish	ACP Order No.	AW Order No.
White	106105	
Stone	105910	
Antique Brass	105927	
Bright Brass	106106	
Polished Chrome	105928	
Brushed Chrome	105929	
Satin Nickel	105911	
Oil Rubbed Bronze	105912	

### Handle Base

Finish	ACP Order No.	AW Order No.
White	106074	
Stone	106075	
Antique Brass	106077	
Bright Brass	106078	
Polished Chrome	106081	
Brushed Chrome	106079	
Satin Nickel	106080	
Oil Rubbed Bronze	106076	

### Handle Screw

**Note:**

¼ - 20 x 1" Pan Head

ACP Order No.	AW Order No.
105448	

## Hardware

### Multi Point Lock Parts

#### Keepers - Roller

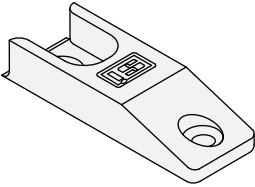
	<b>Note:</b> Applied to sill, head and passive sash, adjacent to mushroom cams (except for head extension). 5 required per unit.	ACP Order No.	AW Order No.
		106288	

#### Keepers - Lead In

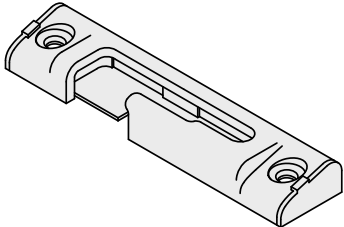
	<b>Note:</b> Applied to sill. 1 required per unit.	ACP Order No.	AW Order No.
		115926	

#### Screw - Lock Mechanism

	<b>Note:</b> #7 x 1" Flat Head SS Screw	ACP Order No.	AW Order No.
		105409	

#### Screw - Head Jamb Keepers

	<b>Note:</b> #8 x 3/4" Flat Head SS Screw	ACP Order No.	AW Order No.
		105813	

#### Screw - Sill & Astragal Keepers

	<b>Note:</b> #8 x 1" Flat Head SS Screw	ACP Order No.	AW Order No.
		1170	

## Frame Assembly - Operating Windows

### Rectangular and Archtop

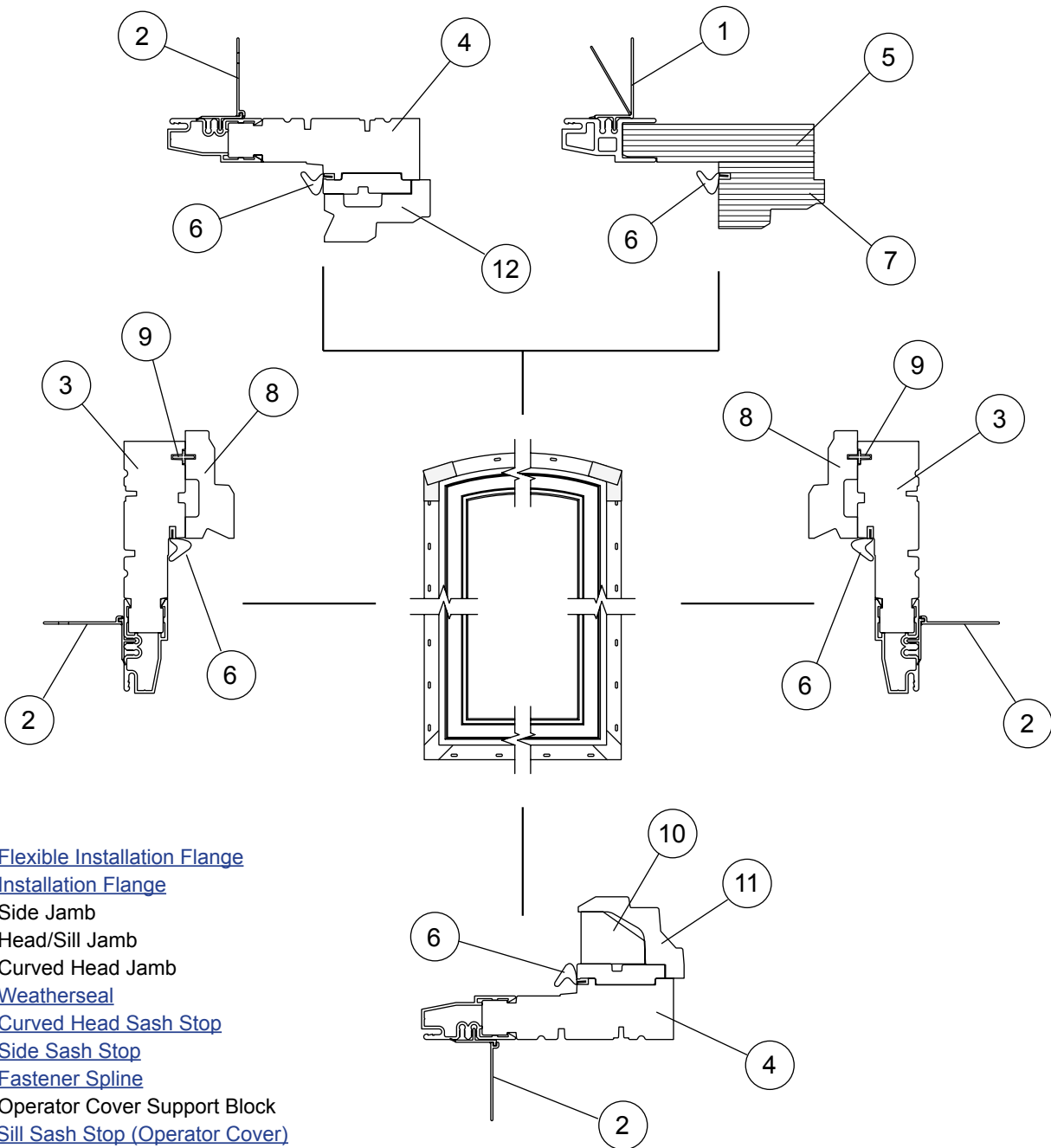

Complementary Clad French Casement Rectangular and Arch Top Windows - Operating Window Frame

## Frames

### Springline™

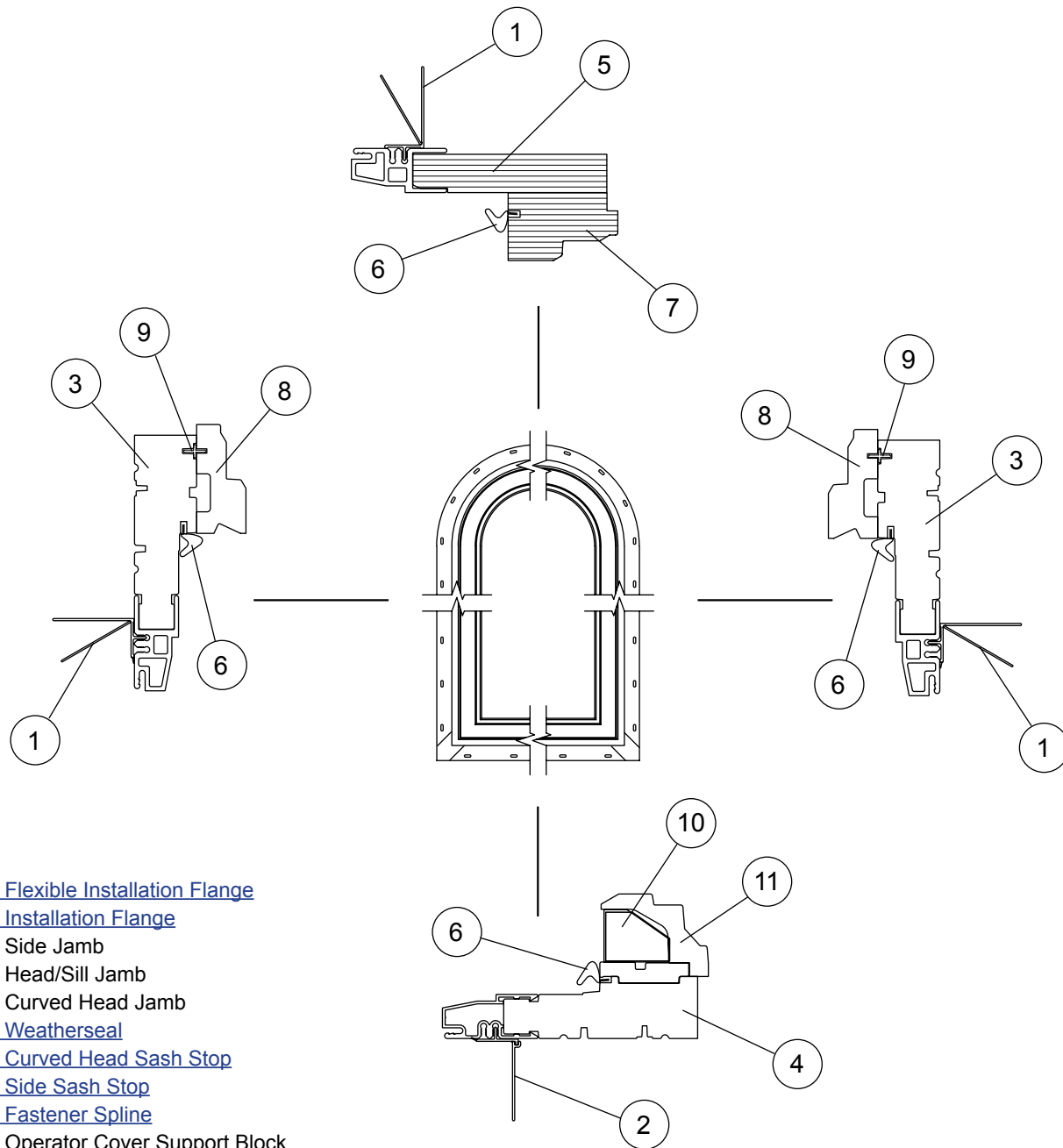

### Complementary Clad French Casement Springline™ Windows - Operating Window Frame



### Frame Assembly - Fixed Windows

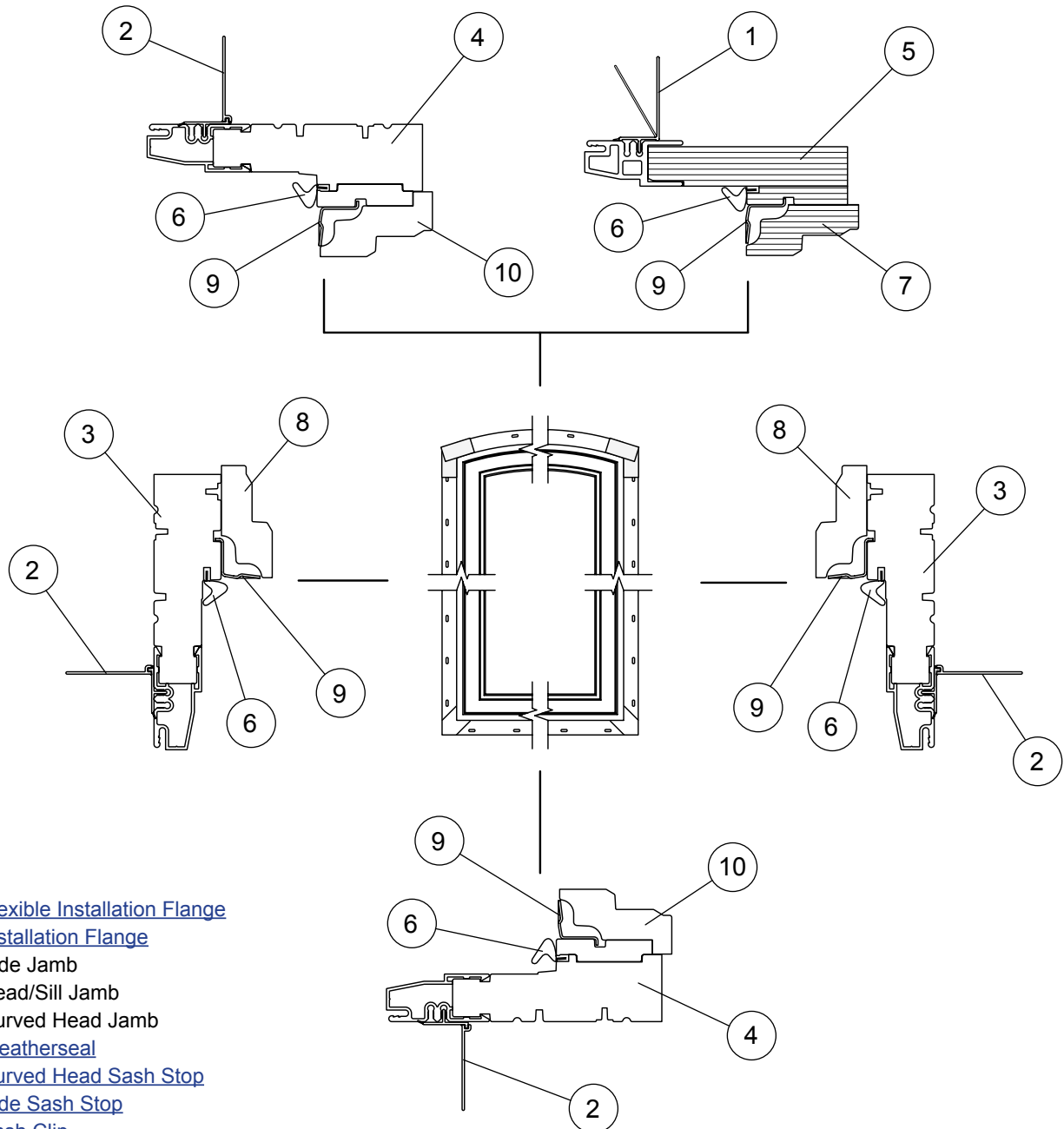

### Complementary Clad French Casement Windows - Fixed Frame

## Frames

### Sash Stops

**Note:**

All sash stops available in pine, oak, mahogany, maple, cherry, Douglas fir, alder, and prefinished white.

**Sash Stop - Operating / Side / Rectangular and Arch Top** Ref. No. 8 [page 33](#) & [34](#) (May 2011 to Present)

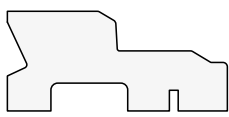
	<b>Note:</b> Used on operating side jambs. When ordering specify left or right side of unit.	ACP Order No.	AW Order No.
		PF2502	

**Sash Stop - Operating / Head / Rectangular** Ref. No. 12 [page 33](#) (May 2011 to Present)

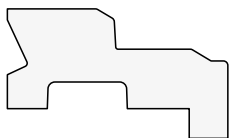
	<b>Note:</b> Used on operating rectangle head jambs.	ACP Order No.	AW Order No.
		PF2503	

**Sash Stop - Operating / Head / Arch Top** Ref. No. 7 [page 33](#)

	<b>Note:</b> Used on operating arch top head jambs.	ACP Order No.	AW Order No.
		PF1891	

**Sash Stop - Operating / Head / Springline™** Ref. No. 7 [page 34](#)

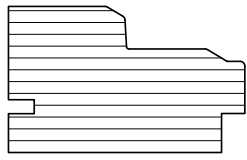
	<b>Note:</b> Used on operating Springline™ head jambs.	ACP Order No.	AW Order No.
		PF1814	

**Sash Stop - Operating / Sill Operator Cover** Ref. No. 11 [page 33](#) & [34](#) (May 2011 to Present)

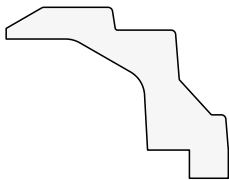
	<b>Note:</b> Used on operating unit sills.	ACP Order No.	AW Order No.
		PF2144	

# Andersen® Complementary Clad French Casement Windows (2005 to Present)

Operating And Fixed Windows

## Frames

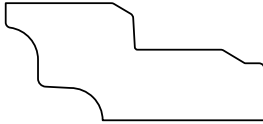
Sash Stop - Fixed / Side Jamb / Lineal    Ref. No. 8 <a href="#">page 35</a>			
	<b>Note:</b> Used on fixed unit side jambs.	ACP Order No.	AW Order No.
		PF1955	

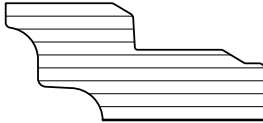
Sash Stop - Fixed / Head Jamb / Curved    Ref. No. 7 <a href="#">page 35</a>			
	<b>Note:</b> Used on fixed arch top and Springline™ head jambs.	ACP Order No.	AW Order No.
		PF1955	

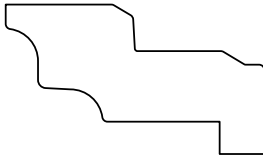
Sash Stop - Fixed / Sill and Rectangle Head    Ref. No. 10 <a href="#">page 35</a>			
	<b>Note:</b> Used on all fixed sills and rectangle head jambs.	ACP Order No.	AW Order No.
		PF1956	

## Frames

### Extension Jambs

**Note:**

All extension jambs are available in pine, oak, mahogany, maple, cherry, Douglas fir, alder, and prefinished white.  
 Custom extension jambs available.

#### Extension Jamb - 1 1/4" / Lineal and Curved

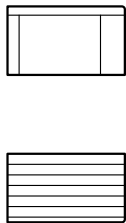
	<b>Note:</b> Used for 4 9/16" wall thickness.	ACP Order No.	AW Order No.
		PF1769	

#### Extension Jamb - 1 15/16" / Lineal and Curved

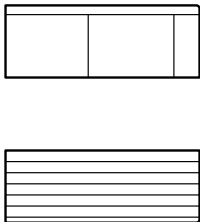
	<b>Note:</b> Used for 5 1/4" wall thickness.	ACP Order No.	AW Order No.
		PF1770	

#### Extension Jamb - 3 1/4" / Lineal and Curved

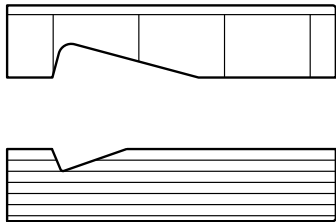
	<b>Note:</b> Used for 6 9/16" wall thickness.	ACP Order No.	AW Order No.
		PF1771	

#### Extension Jamb - 3 3/4" / Lineal and Curved

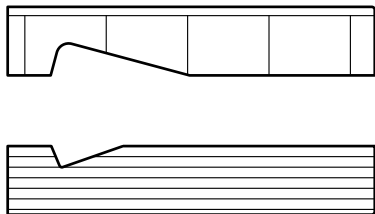
	<b>Note:</b> Used for 7 1/8" wall thickness.	ACP Order No.	AW Order No.
		PF1772	

# Andersen® Complementary Clad French Casement Windows (2005 to Present)

Operating And Fixed Windows

## Frames

### Frame Parts

#### Weatherseal - Frame *Ref. No. 6 page 33, 34 & 35 & No. 10 page 9 (September 2012 to Present)*

		ACP Order No.	AW Order No.
		PF2561	

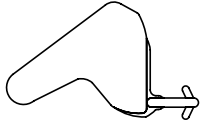

#### Sash Retainer Clip - Fixed *Ref. No. 9 [page 35](#)*

		ACP Order No.	AW Order No.
		107124	

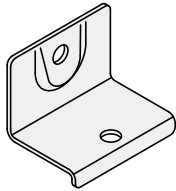

#### Brickmould - Aluminum / Lineal & Curved

	<b>Note:</b> Available in 21 standard and any custom color.	ACP Order No.	AW Order No.
		KM34BM	

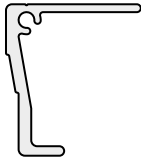

#### Weatherseal - Foam Tape / 2mm x 5/8"

	<b>Note:</b> Used to seal between interior meeting stile cover and operator cover support block at sill.	ACP Order No.	AW Order No.
		106088	

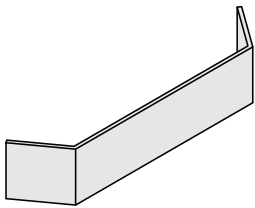

#### Fastener Spline *Ref. No. 9 [page 33](#) & [34](#)*

	<b>Note:</b> Length = 12 inches.	ACP Order No.	AW Order No.
		114310	

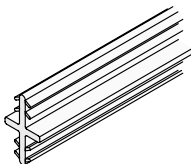





## Joining Components

### Mullion Covers - Interior

**Note:**

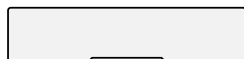
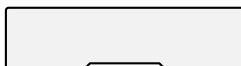
All interior mullion covers are available in pine, oak, mahogany, maple, cherry, Douglas fir, alder, and prefinished white.  
Custom width mullion covers available.

Mullion Cover - Interior / Direct Mullion / Vertical				
		Dimensions	ACP Order No.	AW Order No.
		$\frac{5}{8}'' \times 2 \frac{19}{64}''$	PF1796	
Mullion Cover - Interior / Direct Mullion / Horizontal				
		Dimensions	ACP Order No.	AW Order No.
		$\frac{11}{16}'' \times 2 \frac{19}{64}''$	PF1797	
Mullion Cover - Interior / $\frac{3}{8}''$ Mullion / Vertical				
		Dimensions	ACP Order No.	AW Order No.
		$\frac{5}{8}'' \times 2 \frac{43}{64}''$	PF1798	
Mullion Cover - Interior / $\frac{3}{8}''$ Mullion / Horizontal				
		Dimensions	ACP Order No.	AW Order No.
		$\frac{11}{16}'' \times 2 \frac{43}{64}''$	PF1799	
Mullion Cover - Interior / 2" Mullion / Vertical				
		Dimensions	ACP Order No.	AW Order No.
		$\frac{5}{8}'' \times 4 \frac{9}{32}''$	PF2031	
Mullion Cover - Interior / 2" Mullion / Horizontal				
		Dimensions	ACP Order No.	AW Order No.
		$\frac{11}{16}'' \times 4 \frac{9}{32}''$	PF2036	

# Andersen® Complementary Clad French Casement Windows (2005 to Present)

Operating And Fixed Windows

## Joining Components

### Mullion Covers - Exterior

**Note:**

All exterior mullion covers available in 21 standard and any custom color. Custom width mullion covers available.

#### Mullion Cover - Exterior / Direct Mullion / Aluminum

		ACP Order No.	AW Order No.
		PMC73	

#### Mullion Cover - Exterior / 3/8" Mullion / Aluminum

		ACP Order No.	AW Order No.
		PF1069	

#### Mullion Cover - Exterior / 2" Mullion / Aluminum

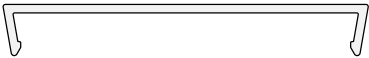
		ACP Order No.	AW Order No.
		PF1070	

#### Mullion Cover - Exterior / Sill / Aluminum

		ACP Order No.	AW Order No.
		KMC25	

#### Mullion Cover - Exterior / Sill / Aluminum

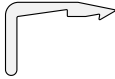
		ACP Order No.	AW Order No.
		PF1038	

## Interior Casing

### Casing Profiles

**Note:**

Interior casings are available in both lineal & curved and in pine, oak, mahogany, Douglas fir, cherry, maple, alder, and prefinished white.

#### Interior Casing - Lineal and Curved / Wood / 2 ¼"



WM-356



WM-376



WM-366

2 ¼" Colonial



WM-324

2 ¼" Ranch

#### Interior Casing - Lineal and Curved / Wood / 2 ½"



WM-315

2 ½" Ranch



WM-351

2 ½" Colonial

#### Interior Casing - Lineal and Curved / Wood / 2 ¾"



LN-366



PF1047



Interior Casing

Interior Casing - Lineal and Curved / Wood / 3 ¼"



Interior Casing - Lineal and Curved / Wood / 3 ½"



3 ½" Colonial

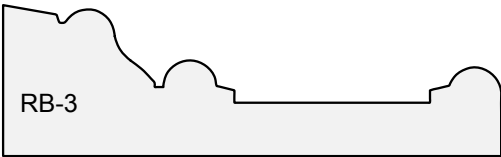
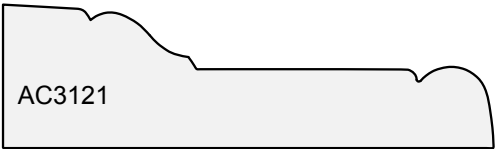

## Interior Casing

### Casing Parts

#### Corner Block

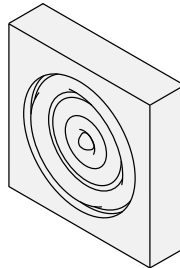

	<b>3" × 3" × 27/32"</b>		<b>3 5/8" × 3 5/8" × 27/32"</b>		<b>4" × 4" × 27/32"</b>	
<b>Species</b>	<b>ACP Order No.</b>	<b>AW Order No.</b>	<b>ACP Order No.</b>	<b>AW Order No.</b>	<b>ACP Order No.</b>	<b>AW Order No.</b>
Pine	105		111		981	
Oak	113		534		982	
Mahogany	103706		103708		103710	
Maple	104224		104225		104226	

	<b>4 5/8" × 4 5/8" × 27/32"</b>	
<b>Species</b>	<b>ACP Order No.</b>	<b>AW Order No.</b>
Pine	1304	
Oak	1305	
Mahogany	103712	
Maple	104227	

#### Keystone

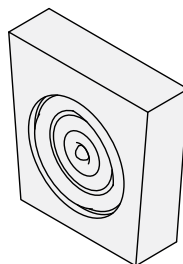

	<b>2 7/8" × 2 7/8" × 27/32"</b>		<b>3 3/4" × 3 3/4" × 27/32"</b>		<b>4 1/2" × 4 1/2" × 27/32"</b>	
<b>Species</b>	<b>ACP Order No.</b>	<b>AW Order No.</b>	<b>ACP Order No.</b>	<b>AW Order No.</b>	<b>ACP Order No.</b>	<b>AW Order No.</b>
Pine	2148		642		2152	
Oak	2149		190		2153	
Mahogany	103698		103700		103702	
Maple	104220		104221		104222	

# Andersen® Complementary Clad French Casement Windows (2005 to Present)

Operating And Fixed Windows

## Interior Casing

### Plinth Block - Arch

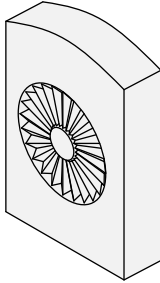

		2 <sup>7</sup> / <sub>8</sub> " × 4"		3 <sup>7</sup> / <sub>8</sub> " × 5 <sup>1</sup> / <sub>4</sub> "	
Species		ACP Order No.	AW Order No.	ACP Order No.	AW Order No.
Maple		107003	9050776	107005	9050778
Oak		107002	9050775	107004	9050777
Mahogany		109825		109827	
Douglas Fir		109821		109823	
Cherry		109817		109819	

### Plinth Block

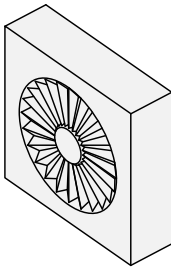

		2 <sup>7</sup> / <sub>8</sub> " × 2 <sup>7</sup> / <sub>8</sub> "		3 <sup>7</sup> / <sub>8</sub> " × 3 <sup>7</sup> / <sub>8</sub> "	
Species		ACP Order No.	AW Order No.	ACP Order No.	AW Order No.
Maple		106999	9050772	107001	9050774
Oak		106998	9050771	107000	9050773
Mahogany		109824		109826	
Douglas Fir		109820		109822	
Cherry		109816		109818	

## Installation Components

### Installation Parts

#### Screw - Long / Hinge / Stainless Steel

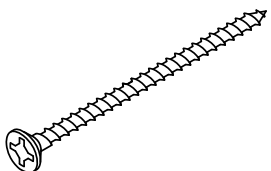
	<b>Note:</b> #10 × 2½" SST FH Screw	ACP Order No.	AW Order No.
		104100	

#### Operator Handle - Temporary

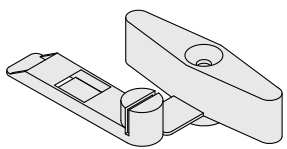
		ACP Order No.	AW Order No.
		105166	

#### Installation Clips - 6"

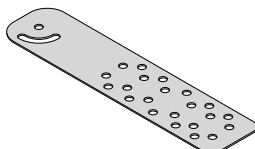
		ACP Order No.	AW Order No.
		112736	

#### Installation Flange - Lineal *Ref. No. 2 [page 33](#), [34](#) & [35](#)*

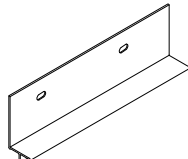
		ACP Order No.	AW Order No.
		PF1214	

#### Installation Flange - Flexible *Ref. No. 1 [page 33](#), [34](#) & [35](#)*

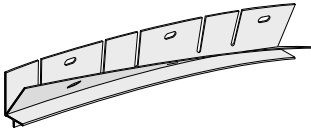
		ACP Order No.	AW Order No.
		PF1886	

#### Flexible Drip Cap

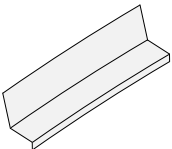
		Color	ACP Order No.	AW Order No.
		Beige	103253	
		White	103252	

## Andersen® Complementary Clad French Casement Windows (2005 to Present)

*Operating And Fixed Windows*

### Installation Components

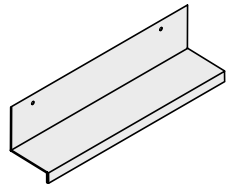
Drip Cap - Aluminum			
		ACP Order No.	AW Order No.
		PF2352	

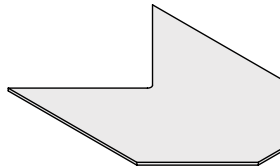
Gasket - Nail Flange / 90° Corner			
		ACP Order No.	AW Order No.
		113018	

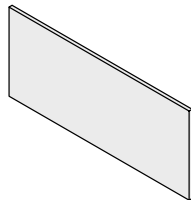
Gasket - Nail Flange / Non 90° Corner			
		ACP Order No.	AW Order No.
		113203	

## Notes

---