

Prefinished Sill Stop and Stool

for Andersen® 200 Series Narroline® Double-Hung Windows



INSTALLER: Please leave this guide with the building owner to file for future reference.

For ease of installation and continued enjoyment of your Andersen® product, please read and follow this Instruction Guide completely. You may direct any questions about this or other products to your local Andersen dealer, found in the Yellow Pages under "Windows", or call Andersen WindowCare® service center at 1-888-888-7020 Monday through Friday, 7 a.m. to 7 p.m. Central Time and Saturday, 8 a.m. to 4 p.m. Central Time. Assembly and installation of Andersen products is the sole responsibility of the architect, building owner, contractor and/or consumer and Andersen has no responsibility in this regard. Thank you for choosing Andersen.

⚠ WARNING

Use of ladders and/or scaffolding and working at elevated levels may be hazardous. Follow equipment manufacturer's instructions for safe operation. Use extreme caution when working around window and door openings. Falling from opening may result in personal injury or death.

⚠ WARNING

Improper use of hand or power tools could result in personal injury and/or product damage. Follow equipment manufacturer's instructions for safe operation. Always wear safety glasses.

⚠ WARNING

Weight of window and door unit(s) and accessories will vary. Use a reasonable number of people with sufficient strength to lift, carry, and install window and door unit(s) and accessories. Always use appropriate lifting techniques.

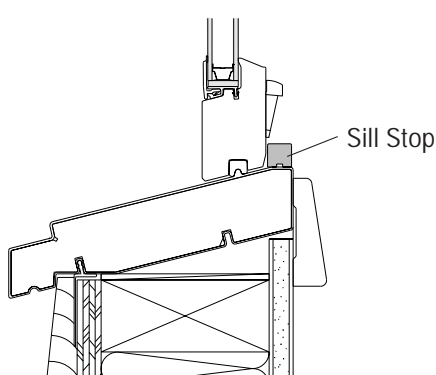

Sill Stop Application

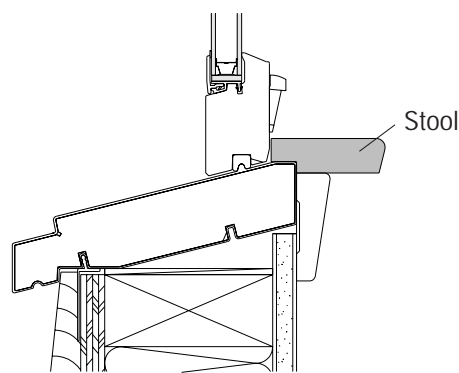

Stool Application

1. Apply Sill Stop/Stool

! CAUTION

DO NOT use silicone sealant on Sill Stop and Stool. Silicone sealant will prevent removal if required.

- Apply butyl caulking to mortised areas of *Side Jambs* and *Sill*. Also apply a bead of butyl caulking in the groove of *Sill Stop* or bottom of *Stool*.
- Position *Sill Stop/Stool* in the *Side Jamb*, flush with inside of *Sill*. *Side Jambs* are mortised to receive *Sill Stop* or *Stool*.
- Check for an even reveal. Allow adequate clearance between *Sill Stop/Stool* and *Lower Sash*. Fasten using 1" (2d) finishing nails through the top of *Sill Stop/Stool* and into *Sill*.

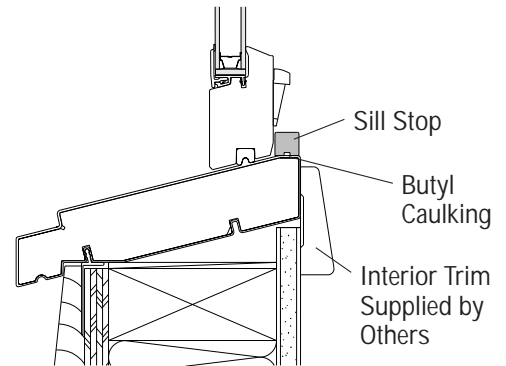
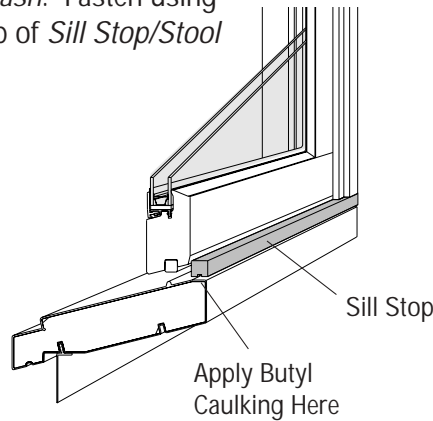
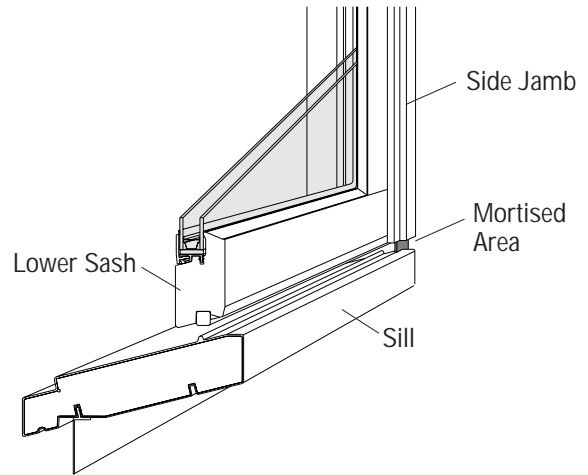

Horizontal Detail* - Sill Stop Application

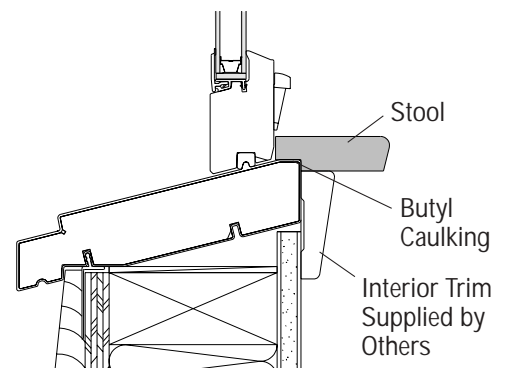
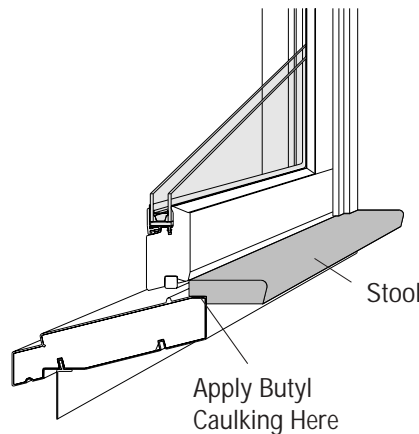

Horizontal Detail* - Stool Application

* Details show unit installed in 4-1/2" wall with Sill Stop or Stool and interior trim applied.