

Interior Extension Jamb Installation Guide

for Andersen® Architectural Fixed Windows

Andersen®
architectural
windows and
doors

IMPORTANT

Read all instructions carefully before attempting this procedure. If you have any questions about your ability to complete this procedure, call Andersen at 1-888-888-7020 for further direction. Andersen WindowCare® service center hours are Monday through Friday, 7 a.m. to 7 p.m. Central Time and Saturday 8 a.m. to 4 p.m. Central Time. Thank you for choosing Andersen® products.

Important Safety, Assembly, and Installation Information

Every assembly and installation is different (windloads, structural support, etc.). Andersen strongly recommends consultation with an Andersen supplier or an experienced contractor, architect, or structural engineer prior to the assembly and installation of any Andersen product. Andersen has no responsibility in regard to the post-manufactured assembly and installation of Andersen products.

⚠ WARNING

Using ladders and/or scaffolding and working at elevated levels may be hazardous. Follow equipment manufacturer's instructions for safe operation. Use extreme caution when working around window and door openings. Falling from opening may result in injury or death.

⚠ WARNING

Improper use of hand/power tools could result in injury and/or product damage. Follow manufacturer's instructions for safe operation of equipment. Always wear safety glasses.

⚠ WARNING

Windows and doors can be heavy. Use safe lifting techniques and a reasonable number of people with enough strength to lift, carry and install window and door products to avoid injury and/or product damage.

Parts Included

Instruction Guide
Extension Jamb Set

Tools and Supplies

- Safety Glasses
- Pencil
- Mitre Saw
- Power Drill
- Phillips Screwdriver
- #6 x 1-5/8" Trim Screw
- #8 x 1-1/2" Pan Head Screw
- 7/32" Drill Bit
- 5/16" Drill Bit
- 1/8" Drill Bit
- 3/32" Drill Bit

Extension Jamb Offset

NOTICE

- *Thin Jamb* units have a 7/64" offset between *Frame* and *Extension Jamb*.
- On *Thick Jamb* units the inside surface of *Extension Jamb* is flush with inside surface of *Frame*.

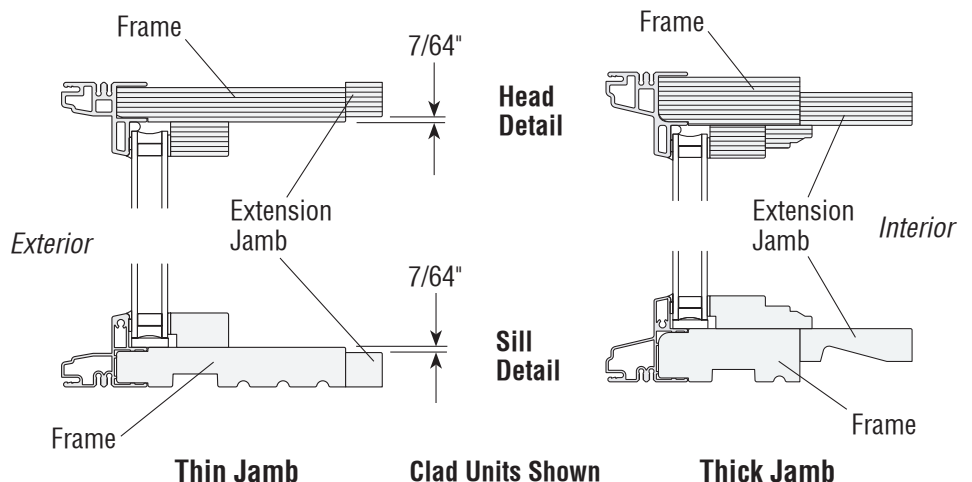

Extension Jamb Application Before Unit Installation

1. Cut Extension Jambs to Size

CAUTION

Curved Extension Jambs can be pushed inwards. **Do Not** push curved Extension Jambs outwards or over compress inwards. Forcing Extension Jambs too far will cause product damage.

NOTICE

Extension Jambs are sent long and must be cut to fit on site.

- Place *Extension Jambs* in position on window unit. Allow for 7/64" offset on *Thin Jamb* units. Curved *Extension Jambs* can be pushed inward slightly to better fit window frame. **Do Not** force curved *Extension Jambs* outwards.
- Mark and cut *Extension Jambs* to size with mitre saw.

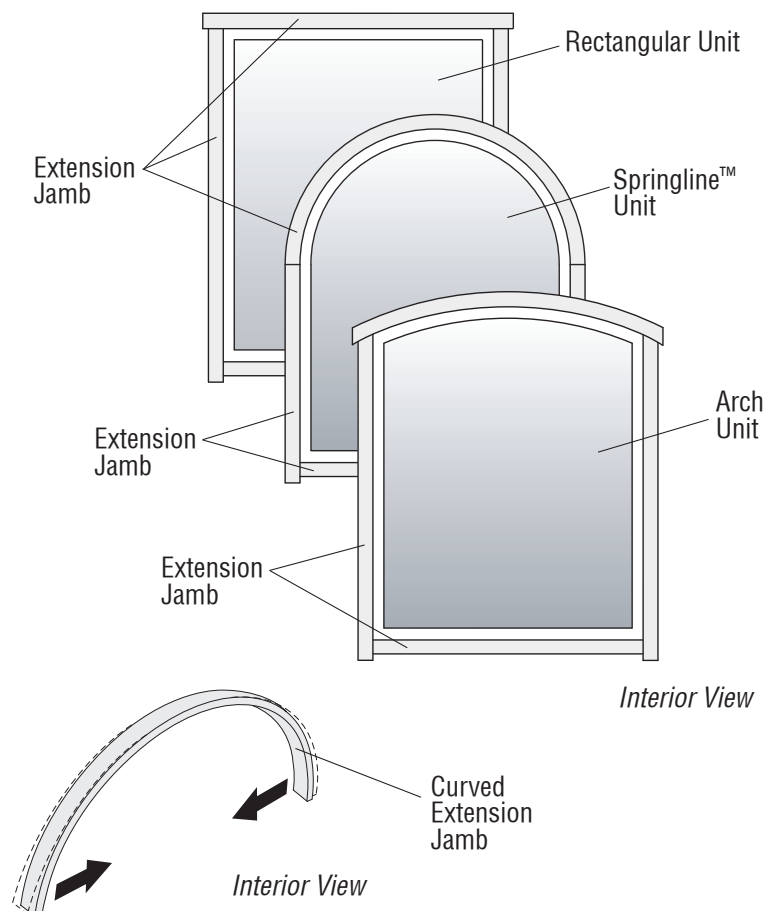

2. Predrill Extension Jambs

Extension Jambs 2" or Wider

- Drill through groove on back side of *Extension Jamb* on 15° angle with 1/8" drill bit. See drawing.
- For *Extension Jamb* with no groove. Drill 1/8" hole on 15° angle 1-3/8" from edge. Counterbore with 5/16" drill bit stopping 5/8" from edge. See drawing.
- Drill holes 3" from each end and every 12" to 16" between.

Extension Jambs Less Than 2" Wide

- Drill 3/32" hole through middle of interior edge. Counterbore *Extension Jambs* wider than 1" with 7/32" drill bit. Counterbore from interior edge and stop 3/4" from other edge.
- Drill holes 3" from each end and every 12" to 16" between.

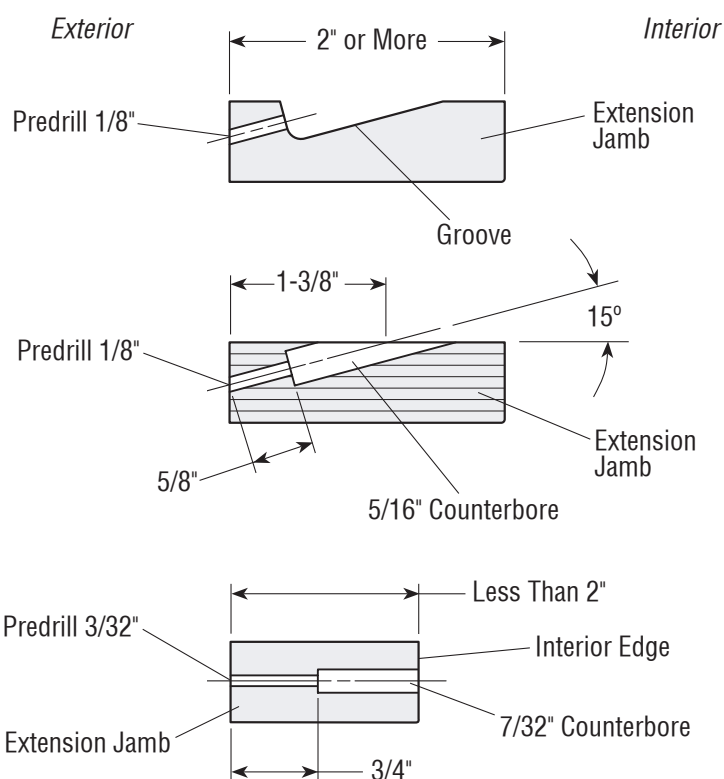

3. Install Extension Jamb

- Install curved or head *Extension Jamb* first. Install side *Extension Jambs* second and sill *Extension Jamb* last.
- Place *Extension Jambs* in position. Maintain $7/64$ " offset on *Thin Jamb* units.
- Secure *Extension Jambs* with screws. If securing through back side of *Extension Jambs* use #8 x 1-1/2" pan head screws. If securing through the interior edge use #6 x 1-5/8" trim screws.
- Predrill and secure corners of *Extension Jambs* using #6 x 1-5/8" trim screws. See drawing.

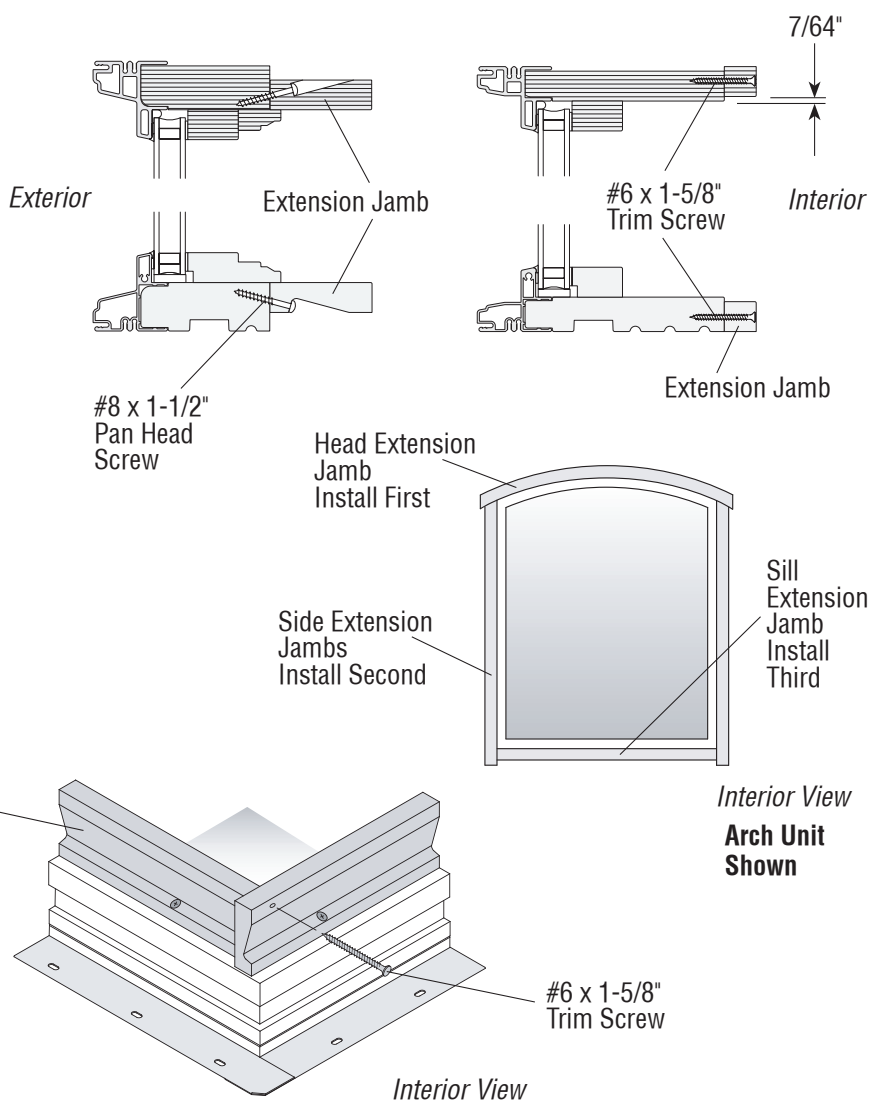

Extension Jamb Application After Unit Installation

NOTICE

After window unit has been installed, follow steps for **Extension Jamb Application Before Unit Installation** if possible. For Extension Jambs 2" or wider not able to secure from back side, secure through interior edge.

- Predrill through middle of interior edge of *Extension Jamb* with $3/32$ " drill bit. Drill holes 3" from each end and every 12" to 16" between.
- Counterbore *Extension Jambs* wider than 1" with $7/32$ " drill bit. Counterbore from interior edge and stop $3/4$ " from other edge.
- Secure *Extension Jamb* with #6 x 1-5/8" trim screws.

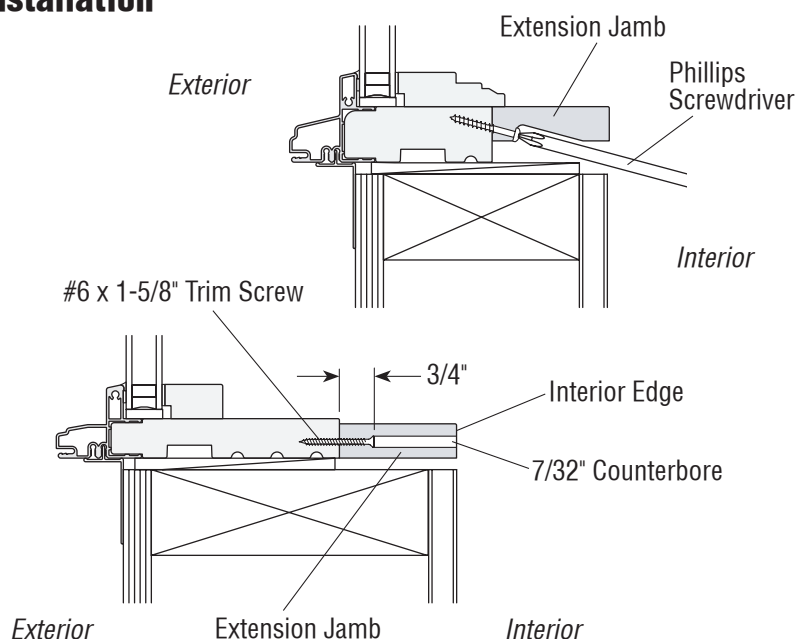

Elliptical Extension Jamb

NOTICE

Elliptical Extension Jamb can be supplied in 2 or 3 pieces. Extension Jamb are sent long and must be cut to fit on site.

- Mark, cut, predrill and install the *Extension Jamb* as described in previous sections.

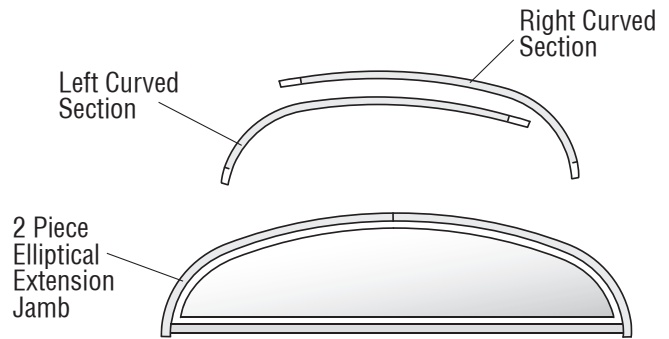

2 Piece Elliptical Construction

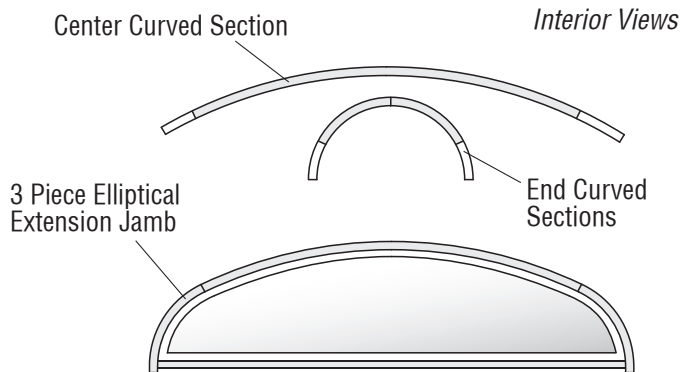

3 Piece Elliptical Construction

Drywall Kerf

NOTICE

The drywall kerf is a groove cut in the interior edge of the frame or Extension Jamb which allows the leg of a drywall return to be inserted as shown in the drawing. Drywall return is supplied by others.

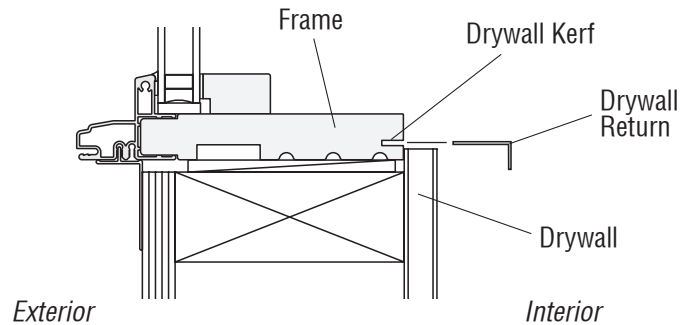

Finishing and Maintenance

CAUTION

DO NOT expose unfinished wood to high moisture conditions, excessive heat or humidity. Finish wood surfaces immediately after installation. Unfinished wood surfaces will discolor, deteriorate, and/or may bow and split.

SURFACE PREPARATION

Set all nails 1/16" below wood surface. Fill all nail holes. Lightly sand all surfaces with 220 grit sandpaper. Remove all dust with a tack cloth or clean damp rag.

FINISHING

Read and follow finishing manufacturer's instructions and warnings on each container of finishing material for priming, painting, staining, and varnishing.

MAINTENANCE

Immediately sand and refinish any wood that becomes stained or mildewed to prevent further discoloration and/or damage. For further information, contact your local Andersen Dealer. Dealers can be found in the Yellow Pages under Windows.