

# Storm/Insect Screen Combination Unit

**Product Series:** 400 and 200 Series

**Product Type:** 400 Series Tilt-Wash Double-Hung Windows

400 Series Woodwright Double-Hung Windows

200 Series Narroline Double-Hung Windows (1968-2012)

DC Double-Hung Windows (1992-1996)

Read these instructions before starting procedure. For additional information visit [www.andersenwindows.com](http://www.andersenwindows.com). For questions call 1-888-888-7020.  
Para obtener una versión en español de esta guía, visite el sitio [www.andersenwindows.com](http://www.andersenwindows.com)

## Parts Included:

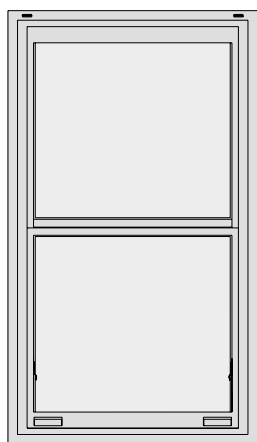

Storm/Insect Screen Combination Unit  
(shown from interior)

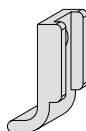

Hanger  
200 Series Narroline Window

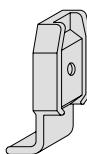

Hanger  
400 Series Woodwright Double-Hung Window  
400 Series Tilt-Wash Double-Hung Window  
DC Double-Hung Window



Anchor Screw



Screw Grommet  
(DC Double-Hung hollow  
core windows only)

## Tools and Supplies Needed:



Safety  
Glasses



Tape  
Measure

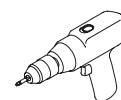

Drill / Driver



Phillips  
Screwdriver



Pencil



3/32" Drill Bit



5/16" Drill Bit  
(DC units only)

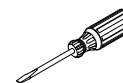

Flat Blade  
Screwdriver



### WARNING



Screen will not stop child from falling out  
window. Keep child away from open window.

# Important Safety and Product Information

## for Andersen® Windows and Doors



This is the Safety Alert Symbol used to alert you to potential injury hazards. Obey all safety messages that follow this symbol to avoid possible injury or death.

### Signal Word and Consequence

**COULD**

Result in:



**WARNING**

Major Injury/Death

**COULD**

Result in:



**CAUTION**

Minor Injury

**COULD**

Result in:

**NOTICE**

Product or Property Damage

**IMPORTANT**

Procedure and Product Information

**Read this Important Safety and Product Information completely before starting.**

### Safety and Product Information Index

■ Tools	■ Glass
■ Handling	■ Protective Film
■ Installation	■ Cleaning
■ Sealing	■ Use/Operation
■ Fastening	■ Joining
■ Finishing	■ Product Information

- Leave this installation instruction with the home/building owner.
- For additional support or help please go to: [andersenwindows.com](https://andersenwindows.com) and visit our Help Center.
- To configure installation instructions go to: [andersenwindows.com/installation](https://andersenwindows.com/installation)

## Tools



**WARNING**

- Follow manufacturers' instructions for hand and power tools. Always wear safety glasses. Failure to do so could result in injury, product or property damage.

## Handling



**WARNING**

- Windows and doors can be heavy. Use safe lifting techniques and a reasonable number of people with enough strength to lift, carry, and install window and door products. Heavier windows and doors will require mechanical assistance. Failure to do so could result in injury, product or property damage.
- **DO NOT** lift or carry window or door by the exterior trim, extension jambs, hardware, or accessories. Doing so could result in injury, product or property damage.
- Windows, doors, and installation components can have sharp edges. Wear protective equipment when handling. Failure to do so could result in injury.
- **DO NOT** drag, rock, cartwheel, or walk windows, doors, sash, or panels across the floor. Doing so could result in product or property damage.

## Installation



**WARNING**

- Use caution when working at elevated heights and around window and door openings. Follow the manufacturers' instructions for ladders and scaffolding. Failure to do so could result in injury or death.
- Support window or door in opening at all times until fully fastened. Failure to do so could result in window or door falling out causing injury, property or product damage.
- Windows and doors have small parts (e.g. hole plugs, operator spline caps, fasteners, etc.). Small parts if swallowed could pose a choking hazard to young children. Dispose of unused, loose, or easily removed small parts. Failure to do so could result in injury.
- Protect surfaces from tool contact. Failure to do so could result in injury, product damage, or surface marring.

## Installation (Continued)

### NOTICE

- Andersen head flashing and installation flanges **DO NOT** take the place of window and door flashing tape or liquid flashing. Window or door must be properly flashed and sealed with a material compatible sealant for protection against water and air infiltration. Failure to do so could result in product or property damage.
- **DO NOT** set window or door directly on installation flange. Doing so could affect product performance, and could result in product or property damage.
- **DO NOT** set window directly on sill plate. Elevate window with shims under the side jambs. Failure to do so could affect operation and product performance, and could result in product damage.
- Window or door must be properly shimmed. Failure to do so could affect operation and product performance, and could result in product damage.
- A continuous full perimeter interior seal between window or door frame and opening is required. Failure to do so will affect product performance, and could result in product or property damage.
- Protect window and door sills during installation and throughout construction. Failure to do so could result in product damage.
- **DO NOT** remove window or door packaging material until instructed to do so. Doing so could result in product damage.

## Sealing

### CAUTION

- Follow instructions of foam, sealant, and flashing manufacturers regarding safety, material application, compatibility, and periodic maintenance for continued weather resistance of their products. Failure to do so could result in injury, product or property damage.

### NOTICE

- Clean and prepare surfaces receiving sealant following sealant manufacturer's instructions. Failure to do so could result in water infiltration causing product or property damage.
- **DO NOT** use abrasive cleaners or solvents when cleaning Fibrex® material. Doing so could result in product damage. Go to [andersenwindows.com](http://andersenwindows.com) for a list of recommended cleaners.

## Fastening

### WARNING

- Metal fasteners and components could corrode when exposed to preservative-treated or fire-retardant treated lumber. Use approved fasteners and components to fasten window or door. Failure to do so could cause a failure resulting in injury, product or property damage.
- Fastener must attach to a structural framing member with a 1-1/2" minimum fastener embedment. Failure to do so could result in injury, product or property damage.
- **DO NOT** remove screws that attach installation clips or gusset plates to window or door frames. Doing so could result in injury, product or property damage.

### NOTICE

- Use masonry screws when fastening directly into masonry or through a buck into masonry. Failure to do so could affect product performance, and could result in product or property damage.
- **DO NOT** over drive screws or nails. Doing so could result in product damage.
- Fasteners must be attached to a structural framing member. Failure to do so will reduce the structural performance to less than published values and could affect product performance, and could result in product or property damage.

## Finishing

### NOTICE

- **DO NOT** stain or paint weatherstrip, vinyl, glass, or hardware. Doing so could result in product damage.
- Read and follow finish manufacturer's instructions and safety information. Failure to do so could result in product damage.
- **DO NOT** over load brush with stain or paint when finishing. Doing so could allow finish to wick between glass stop or grille, and glass.

## Finishing (Continued)

### NOTICE

- Finish all wood surfaces immediately after installation. Unfinished wood will deteriorate, discolor, and could bow or split. Some surfaces are hidden from view.

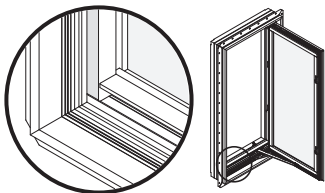

- Some products are shipped unassembled, and it may be more convenient to finish wood surfaces for these products prior to assembly and installation.

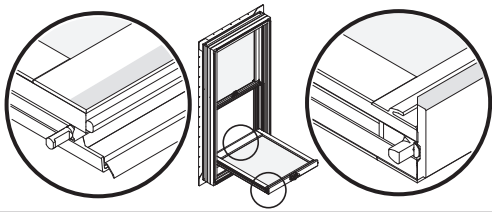

## Glass

### WARNING

- Unless specifically ordered, Andersen windows are not equipped with safety glass, and if broken, could fragment causing injury. Many laws and building codes require safety glass in locations adjacent to or near doors. Andersen windows are available with safety glass that could reduce the likelihood of injury when broken. Information on safety glass is available from your local Andersen dealer.
- Tempered or laminated safety glass is not standard for windows and must be special ordered. Check local building codes for required locations. Failure to do so could result in injury, product or property damage.

### NOTICE

- **DO NOT** apply any type of film to insulating glass. Doing so could cause thermal stress conditions and result in glass damage. Shading devices (e.g. insulated coverings, shutters, etc.) could also cause thermal stress and condensation causing deterioration of windows or doors.

- **DO NOT** use sealants on exterior or interior glass surface.

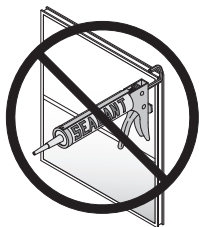

## Protective Film

### WARNING

- **DO NOT** place suction grips over film seams on glass. Suction grips will not hold if placed over film seam to lift or move window or door. Window or door will fall and could result in injury, product or property damage.



- **DO NOT** remove any protective film near flammable materials. Static charge created when removing film can ignite flammable materials or cause a shock. Doing so could result in injury, product or property damage. See warning label on glass.

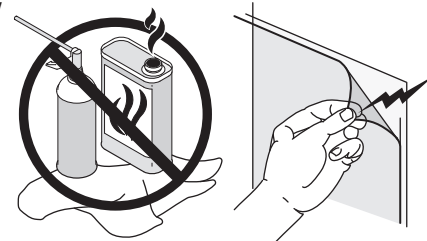

- Dispose of protective film immediately after removing. Failure to do so could pose a suffocation hazard to children.

### NOTICE

- **DO NOT** remove protective film from glass until after construction is completed. Doing so could allow glass to be damaged.
- Remove protective film from non-glass components immediately after installation. Failure to do so could result in product damage.

## Cleaning

### NOTICE

- Acid solutions used for cleaning masonry or concrete will damage all components of window or doors. Protect window or door and follow cleaning product manufacturer's instructions. If acid contacts window or door, wash all surfaces immediately with clean water.

- **DO NOT** use or apply solvents, abrasives, harsh chemicals or cleaners to window or door components. Doing so will result in product damage. For a list of recommended cleaners go to: [andersenwindows.com](http://andersenwindows.com)

- **DO NOT** use metal razor blades to clean glass surface. Glass damage could result.

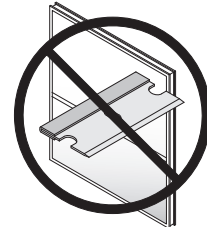

## Use/Operation

### **WARNING**

- **DO NOT** stand in front of or near windows or doors during a storm. Doing so could result in injury. Accessories such as grilles, art glass, and insect screens could dislodge and become airborne if window or door is impacted by wind-borne debris from severe storms or hurricane strength winds. In the event of a storm, remove all accessories from windows or doors and move to a safe location.

- **DO NOT** install air conditioner in window. Doing so could result in injury, product or property damage.



- Wind load brackets must be flipped out when not tilting or cleaning. If wind load brackets are not flipped out, window could blow in resulting in potential injury and/or product damage.

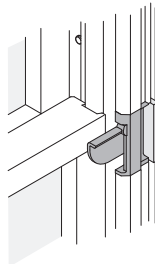

Flipped Out

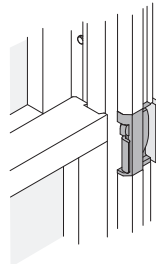

Flipped In

### **CAUTION**

- **DO NOT** attach objects or accessories to window or door except Andersen® products specifically designed for the window or door. Doing so could result in injury, product or property damage.

## Joining

### **WARNING**

- **DO NOT** join any window or door, horizontally or vertically, to any window or door not designed for joining. Doing so could result in injury, product or property damage.

- Joined windows or doors must be individually supported in the opening. Failure to do so could affect operation and product performance, and could result in product or property damage.

## Product and General Information

### **IMPORTANT**

- Buildings constructed prior to 1978 could contain lead paint which could be disturbed during window or door replacement. For more information on proper management of lead paint, go to: [www.epa.gov/lead](http://www.epa.gov/lead)

- Instructions may not be right for all installations due to building design, construction materials, or methods used and/or building or site conditions. Consult a contractor or architect for recommendations.

- Installation flanges may need to be removed for some installations. (e.g. masonry, replacement), or where exterior finish is already applied (e.g. siding, brick veneer, stucco).

- Installation flange on the window or door alone will not properly flash and seal the window or door.

- **DO NOT** remove band, plastic ties, or packing clips from window or door until instructed.

- **DO NOT** remove performance (NFRC) label until after final inspection. Doing so could delay final inspection and sign-off by the code official.

- Check with your local building code official to identify and confirm compliance with local building code requirements.

- Contact local authorities or waste management company for proper recycling and disposal instructions for removed window or door.

- For cleaning instructions for window and door components go to: [andersenwindows.com](http://andersenwindows.com).

- During construction protect products from construction debris, harsh chemical such as brick wash, roof runoff, and cement/masonry which can cause damage to window and door products.

- Protective film is not present on all windows or doors. Protective film is not a substitute for masking.

- Remove protective film from glass within six (6) months of installation and when temperature is above 32° F.

- Remove protective film by peeling from seam or corner. Use a plastic scraper to start if needed.

- Extension jambs can be factory applied on some windows or field applied prior to installation. **DO NOT** apply extension jambs prior to window or door installation that will be fastened with installation clips. Doing so could prevent access to installation clips for fastening.

- For extension jamb application refer to instructions included with part(s) or go to: [andersenwindows.com](http://andersenwindows.com)

- Use painters masking tape for protecting products during construction. Avoid using duct or packaging tapes.

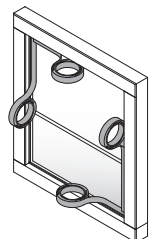



## 1. Identify Window Unit Type

### IMPORTANT

Before proceeding, determine the type of Double-Hung window the Storm/Insect Screen Combination Unit will be installed on **400 Woodwright Double-Hung, 400 Series Tilt-Wash Double-Hung, 200 Series Narroline Double-Hung or DC Double-Hung** units. Follow steps and use components pertaining to your particular window type. Determine window type by inspecting the Outer Frame from the exterior for the existence of a groove. If unit has a groove, it is a **DC Double-Hung** unit. If no groove exists, the unit is a **400 Series Woodwright Double-Hung, 400 Series Tilt-Wash Double-Hung or 200 Series Narroline Double-Hung** unit.

#### 400 Series Woodwright Double-Hung, 400 Series Tilt-Wash Double-Hung and 200 Narroline Double-Hung Units

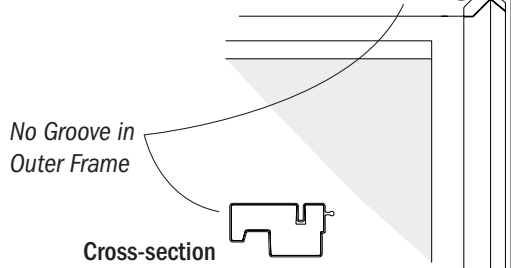

#### DC Double-Hung Units

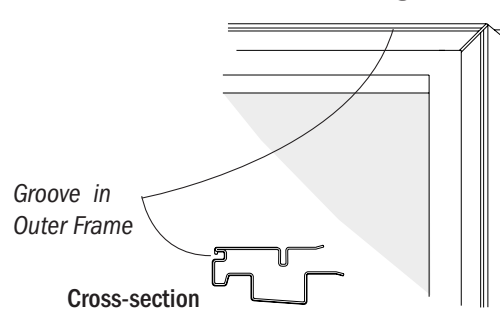

## 2. Prepare for Installation

### Interior of Storm/Insect Screen Combination Unit

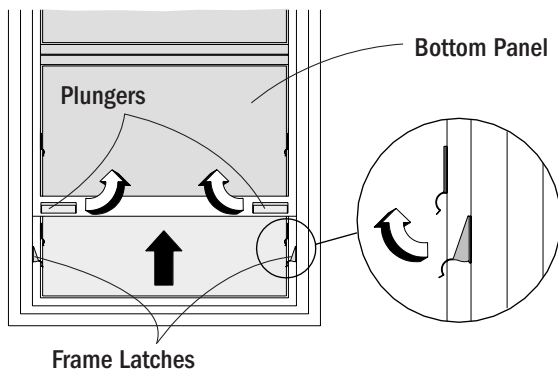

- Open the Bottom Sash on the double-hung window unit.
- Remove the Storm/Insect Screen Combination Unit from carton and place upright, with interior side toward you. Remove packing material.
- Pull the Plunger Handles inward and lift Bottom Panel up approximately 10 inches until Panel engages in the first notch.
- Open Frame Latches on both sides of Storm/Insect Screen Combination Unit.

## 3. Insert Hangers in Storm/Insect Screen Combination Unit

### IMPORTANT

Use the correct Hanger for your window type. **400 Series Woodwright Double-Hung, 400 Series Tilt-Wash Double-Hung, and DC Double-Hung** units have sash that tilt-in for cleaning, **200 Series Narroline** units do not.

- Insert the Hangers for your window type, into the slots on the interior side of the Storm/Insect Screen Combination Unit and turn downward.

#### 400 Series Woodwright Double-Hung, 400 Series Tilt-Wash Double-Hung, and DC Double-Hung Hangers

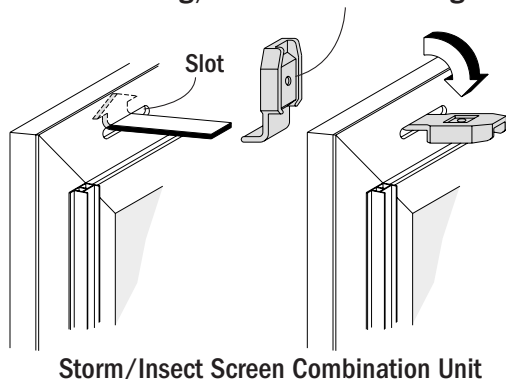

Storm/Insect Screen Combination Unit

#### 200 Series Narroline Double-Hung Hangers

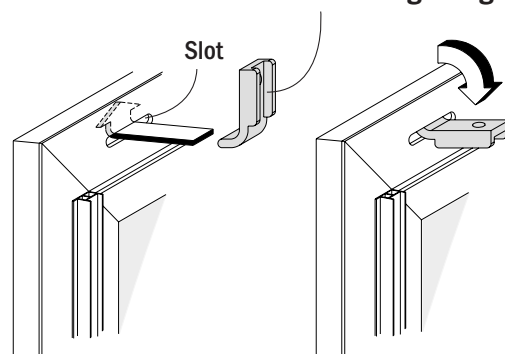

Storm/Insect Screen Combination Unit

## 4. Position Storm/Insect Screen Combination Unit in Window Frame

### **WARNING**

Use a sufficient number of people to support the Storm/Insect Screen Combination Unit during installation. Failure to provide sufficient support could result in serious personal injury and/or product damage.

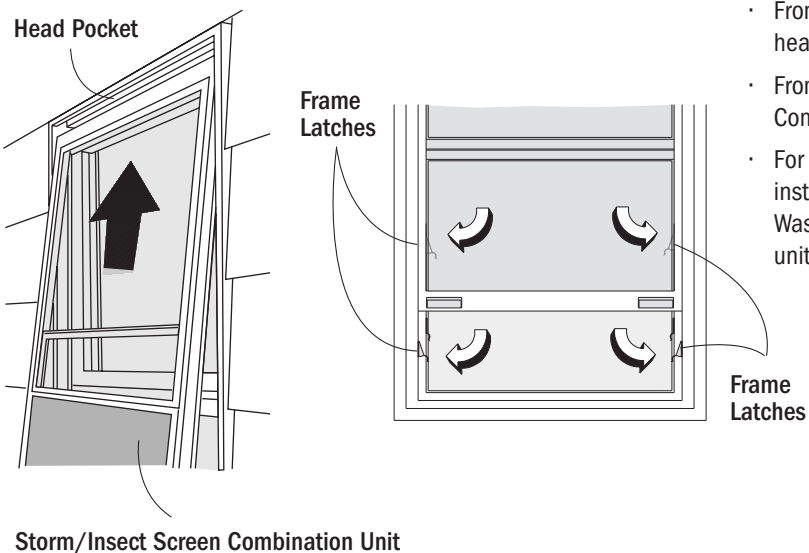

- From the exterior, slide Storm/Insect Screen Combination Unit into head pocket of window unit and push inward against window frame.
- From the interior push the Frame Latches on the Storm/Insect Screen Combination Unit into the slots.
- For DC Double-Hung Window Units Only, Proceed to **Step 6** to continue installation. For 400 Series Woodwright Double-Hung, 400 Series Tilt-Wash Double-Hung, and 200 Series Narroline Double-Hung Window units, proceed to **Step 5**.

## 5. Attach Hanger to Outer Frame

- DC Double-Hung Windows proceed to Step 6.
- Position Hanger against outer frame as shown and place a pencil mark through hole.
- Drill on pencil mark using a 3/32" drill bit 3/8" deep.
- Secure Hangers to outer frame using Anchor Screws provided.
- Installation is now complete for 400 Series Woodwright Double-Hung, 400 Series Tilt-Wash Double-Hung and 200 Series Narroline Double-Hung Units.

### 400 Series Tilt-Wash Units

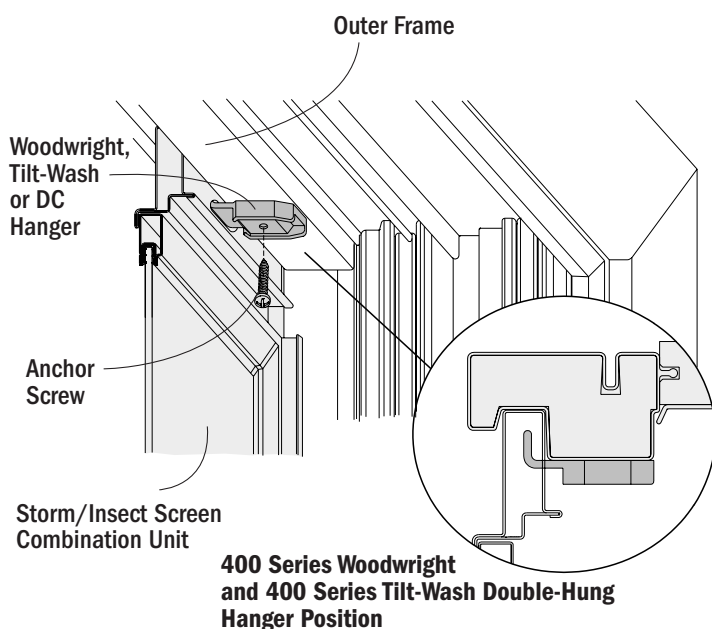

### 200 Series Narroline Units

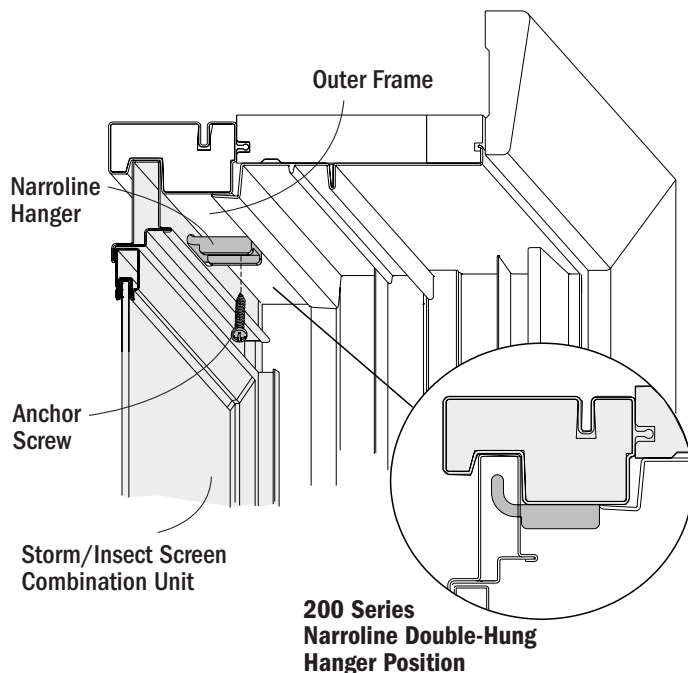

## 6. Mark Screw Grommet Location

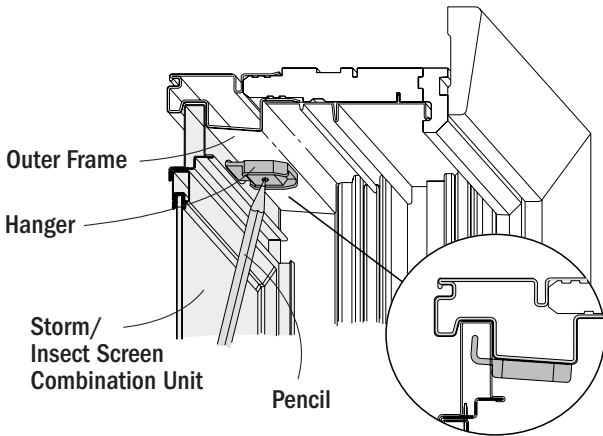

- Close bottom sash on DC Double-Hung Unit.
- Open top sash on DC Double-Hung Unit.
- Position Hangers against frame as shown. Place a pencil mark inside holes to mark Screw Grommet locations.
- Open Frame Latches and remove Storm/Insect Screen Combination Unit from the exterior.

## 7. Predrill Screw Grommet Holes

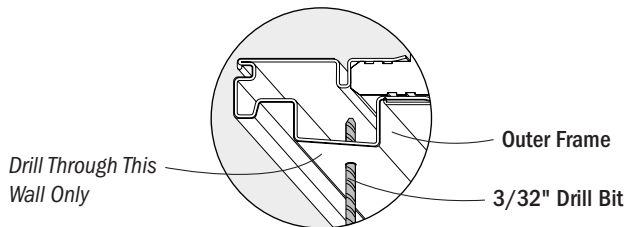

### NOTICE

Drill only through outside wall of outer frame when predrilling. Drilling through both walls of outer frame could result in product or property damage.

- Predrill holes on center of pencil marks using a 3/32" drill bit. Drill only through outside wall of outer frame.

## 8. Enlarge Holes and Insert Screw Grommets

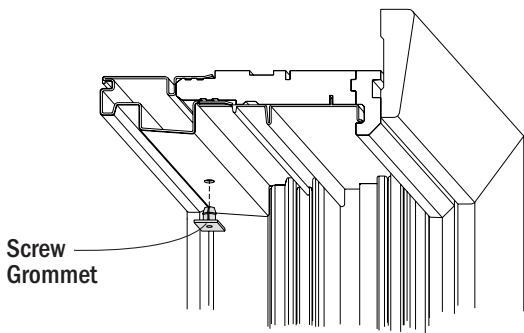

### WARNING

Screw Grommet Holes must be 5/16" in diameter. Larger holes may allow Screw Grommets and Storm/Insect Screen Combination Unit to fall out causing personal injury or damage to product.

- Enlarge holes using a 5/16" (0.3125) drill bit. Drill only through outside wall of frame.
- Insert Screw Grommets into holes. Tap lightly with a hammer to seat if necessary.
- Position grommet head parallel with frame edge to allow attachment of Hanger.

## 9. Reinstall Storm/Insect Screen Combination Unit

- Repeat **STEP 4** of this guide to reinstall Storm/Insect Screen Combination Unit.

## 10. Secure Storm/Insect Screen Combination Unit to Frame

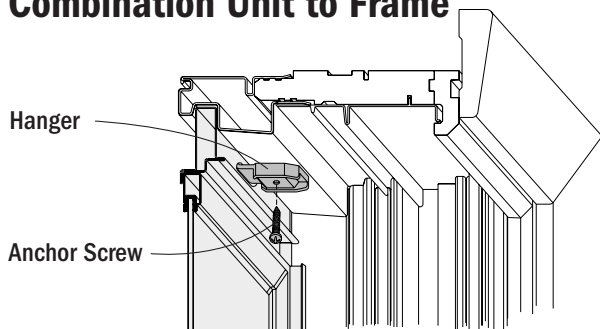

### WARNING

Do not over tighten anchor screws. Over tightening anchor screws may allow Screw Grommets and Storm/Insect Screen Combination Unit to fall out causing personal injury or damage to product.

- Make sure holes in Hangers align with holes in Screw Grommets. Secure using the anchor screws provided, tighten until snug.
- Check that frame latches are engaged.
- **Installation is now complete for DC Double-Hung units.**



## Removing Insect Screens and Storm Panels

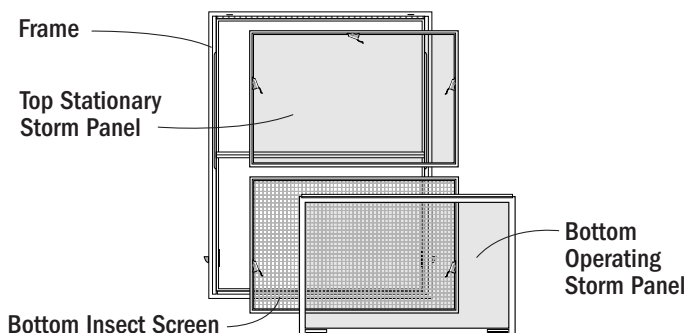

### Removing Insect Screens and Storm Panels

The Andersen Storm/Insect Screen Combination Unit is comprised of a frame complete with vinyl tracks, locking devices and interlocking meeting rail:

- One Top Stationary Storm Panel.
- One Bottom Operating Storm Panel.
- One Bottom Insect Screen Panel.

### Lower Panel Removal

- Push plungers on Bottom Storm Panel towards center and lift panel high enough to expose Frame Latches. (Approx. 10")
- Pull Frame Latches to open position.
- Push bottom of Storm/Insect Screen Combination Frame outward.
- Push Plungers toward center and lift Lower Storm Panel until it is free of Side Channels.
- Bring Bottom Storm Panel to inside and slide down and out through the open Bottom sash of window.
- Reverse removal procedures to reinstall panel.

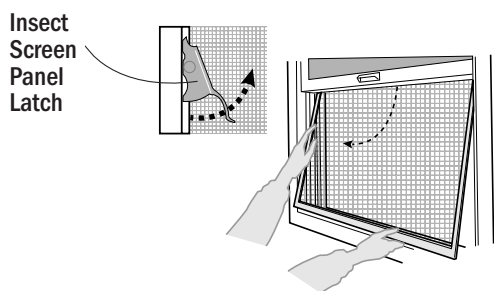
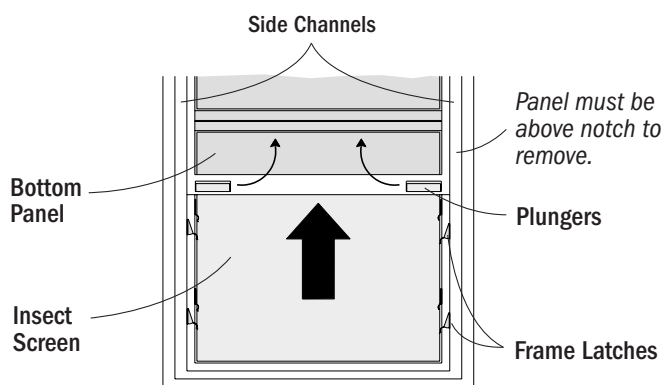

### Insect Screen Removal

- Lift Insect Screen upward and swing bottom of Insect Screen inward. Pull to inside to remove.
- Reverse procedure to install Insect Screen and Bottom Panel.

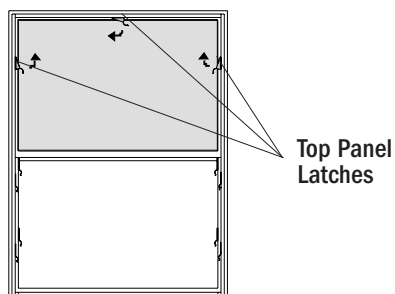

### Top Panel Removal

- Unlock Latches of Top Storm Panel and take panel out.
- Reverse procedure to install Top Storm Panel.

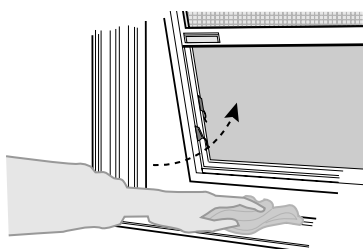

### Cleaning Window Sill

- Push plungers on Lower Storm Panel towards center and lift panel high enough to expose Frame Latches. (Approx. 10")
- Pull Frame Latches to open position.
- Carefully push bottom of Storm/Insect Screen Combination unit away from Window Sill. Hangers at head will hold Storm/Insect Screen Combination unit and allow it to swing out for cleaning the Window Sill.

This page has been intentionally left blank.